

United States Department of the Interior  
National Park Service

NATIONAL REGISTER OF HISTORIC PLACES  
REGISTRATION FORM

=====

1. Name of Property

=====

historic name: Warrens Bridge

other name/site number: PH0248

=====

2. Location

=====

street & number: County Road 14I at its crossing of Lambrook Levee Ditch

not for publication: N/A

city/town: Lambrook

vicinity: X

state: AR county: Phillips code: AR 107 zip code: 72353

=====

3. Classification

=====

Ownership of Property: Public-local

Category of Property: Structure

Number of Resources within Property:

Contributing	Noncontributing	
<u>      </u>	<u>      </u>	buildings
<u>      </u>	<u>      </u>	sites
<u>  1  </u>	<u>      </u>	structures
<u>      </u>	<u>      </u>	objects
<u>  1  </u>	<u>  0  </u>	Total

Number of contributing resources previously listed in the National Register: N/A

Name of related multiple property listing: Historic Bridges of Arkansas

\_\_\_\_\_

=====  
**4. State/Federal Agency Certification**  
=====

As the designated authority under the National Historic Preservation Act of 1986, as amended, I hereby certify that this X nomination \_\_\_\_\_ request for determination of eligibility meets the documentation standards for registering properties in the National Register of Historic Places and meets the procedural and professional requirements set forth in 36 CFR Part 60. In my opinion, the property X meets \_\_\_\_\_ does not meet the National Register Criteria. \_\_\_\_\_ See continuation sheet.

Carlynn A. Slator  
Signature of certifying official

4-5-95  
Date

Arkansas Historic Preservation Program  
State or Federal agency and bureau

In my opinion, the property \_\_\_\_\_ meets \_\_\_\_\_ does not meet the National Register criteria. \_\_\_\_\_ See continuation sheet.

\_\_\_\_\_  
Signature of commenting or other official

\_\_\_\_\_  
Date

\_\_\_\_\_  
State or Federal agency and bureau

=====  
**5. National Park Service Certification**  
=====

I, hereby certify that this property is:

- \_\_\_\_ entered in the National Register \_\_\_\_\_  
    \_\_\_\_ See continuation sheet.
- \_\_\_\_ determined eligible for the \_\_\_\_\_  
    National Register \_\_\_\_\_  
    \_\_\_\_ See continuation sheet.
- \_\_\_\_ determined not eligible for the \_\_\_\_\_  
    National Register \_\_\_\_\_
- \_\_\_\_ removed from the National Register \_\_\_\_\_
- \_\_\_\_ other (explain): \_\_\_\_\_

\_\_\_\_\_  
Signature of Keeper      Date  
                                         of Action

=====  
**6. Function or Use**  
=====

Historic: TRANSPORTATION      Sub: Road-related  
\_\_\_\_\_  
\_\_\_\_\_  
Current: TRANSPORTATION      Sub: Road-related  
\_\_\_\_\_  
\_\_\_\_\_

=====  
**7. Description**  
=====

Architectural Classification:

Other  
\_\_\_\_\_  
\_\_\_\_\_

Other Description: Timber trestle

Materials:	foundation	<u>Wood</u>	roof	<u>N/A</u>
	walls	<u>N/A</u>	other	<u>Timber deck</u>

Describe present and historic physical appearance. X See continuation sheet.

=====  
**8. Statement of Significance**  
=====

Certifying official has considered the significance of this property in relation to other properties: Local.

Applicable National Register Criteria: C

Criteria Considerations (Exceptions): N/A

Areas of Significance: ENGINEERING  
\_\_\_\_\_  
\_\_\_\_\_  
\_\_\_\_\_

Period(s) of Significance: 1930-1939

Significant Dates: 1930

Significant Person(s): N/A  
\_\_\_\_\_

Cultural Affiliation: N/A

Architect/Builder: Unknown  
\_\_\_\_\_  
\_\_\_\_\_

State significance of property, and justify criteria, criteria considerations, and areas and periods of significance noted above.  
X See continuation sheet.

=====  
**9. Major Bibliographical References**  
=====

See "Historic Bridges of Arkansas" MPS Nomination, Section H.

\_\_\_ See continuation sheet.

Previous documentation on file (NPS):

- \_\_\_ preliminary determination of individual listing (36 CFR 67) has been requested.
- \_\_\_ previously listed in the National Register
- \_\_\_ previously determined eligible by the National Register
- \_\_\_ designated a National Historic Landmark
- \_\_\_ recorded by Historic American Buildings Survey # \_\_\_\_\_
- \_\_\_ recorded by Historic American Engineering Record # \_\_\_\_\_

Primary Location of Additional Data:

- X State historic preservation office
- \_\_\_ Other state agency
- \_\_\_ Federal agency
- \_\_\_ Local government
- \_\_\_ University
- \_\_\_ Other -- Specify Repository: \_\_\_\_\_

=====  
**10. Geographical Data**  
=====

Acreage of Property: Less than one

UTM References:	Zone	Easting	Northing	Zone	Easting	Northing
A	<u>15</u>	<u>682920</u>	<u>3800980</u>	B	<u>15</u>	_____
C	<u>15</u>	_____	_____	D	<u>15</u>	_____

\_\_\_ See continuation sheet.

Verbal Boundary Description: \_\_\_ See continuation sheet.

Beginning at a point formed by the intersection of the western edge of County Road 14I with a perpendicular line running parallel with the northern end of the bridge and located approximately 25 feet to the north thereof, proceed westerly for a distance of approximately 25 feet to its intersection with a perpendicular line running parallel with the bridge's western side; thence proceed southerly along said line for a distance of approximately 150 feet to its intersection with a perpendicular line; thence proceed easterly along said line for a distance of approximately 66 feet to its intersection with a perpendicular line; thence proceed northerly along said line for a distance of approximately 150 feet to its intersection with a perpendicular line; thence proceed westerly to the point of beginning.

Boundary Justification: \_\_\_ See continuation sheet.

This boundary includes all the property historically associated with this resource.

=====  
11. Form Prepared By  
=====

Name/Title: Ken Story, National Register/Survey Coordinator  
Organization: Arkansas Historic Preservation Program Date: 04/04/95  
Street & Number: 323 Center Street, Suite 1500 Telephone: (501) 324-9880  
City or Town: Little Rock State: AR Zip: 72201

**United States Department of the Interior  
National Park Service**

## **National Register of Historic Places Continuation Sheet**

Section number   7   Page   1  

---

### **Description**

Located on Phillips County Road 14I at the point where it crosses Lambrook Levee Ditch, the Warrens Bridge is of the timber trestle type. It consists of a total of seven spans, the longest of which measures 15 feet. Its total length is 100 feet and its overall width is 16 feet. Its abutments are of timber construction, as are its six sets of piers, each set including four round wooden supports with a single diagonal cross brace. The deck is constructed of timber also.

United States Department of the Interior  
National Park Service

## National Register of Historic Places Continuation Sheet

Section number 8 Page 1

---

### Significance

Constructed in 1930, the Warrens Bridge is associated with the *Arkansas Highway and Transportation Era* historic context and is of the timber wooden trestle type. Though the identity of its original designer does not survive, it was constructed in conjunction with the Arkansas State Highway Commission and thus may well have been designed by one of that state agency's engineers. Given its relatively intact condition it retains sufficient integrity to remain associated with its historic period and is thus locally eligible under Criterion C.

ARKANSAS  
7.5 MINUTE SERIES (TOPOGRAPHIC)  
SE/4 INDIAN BAY 15' QUADRANGLE

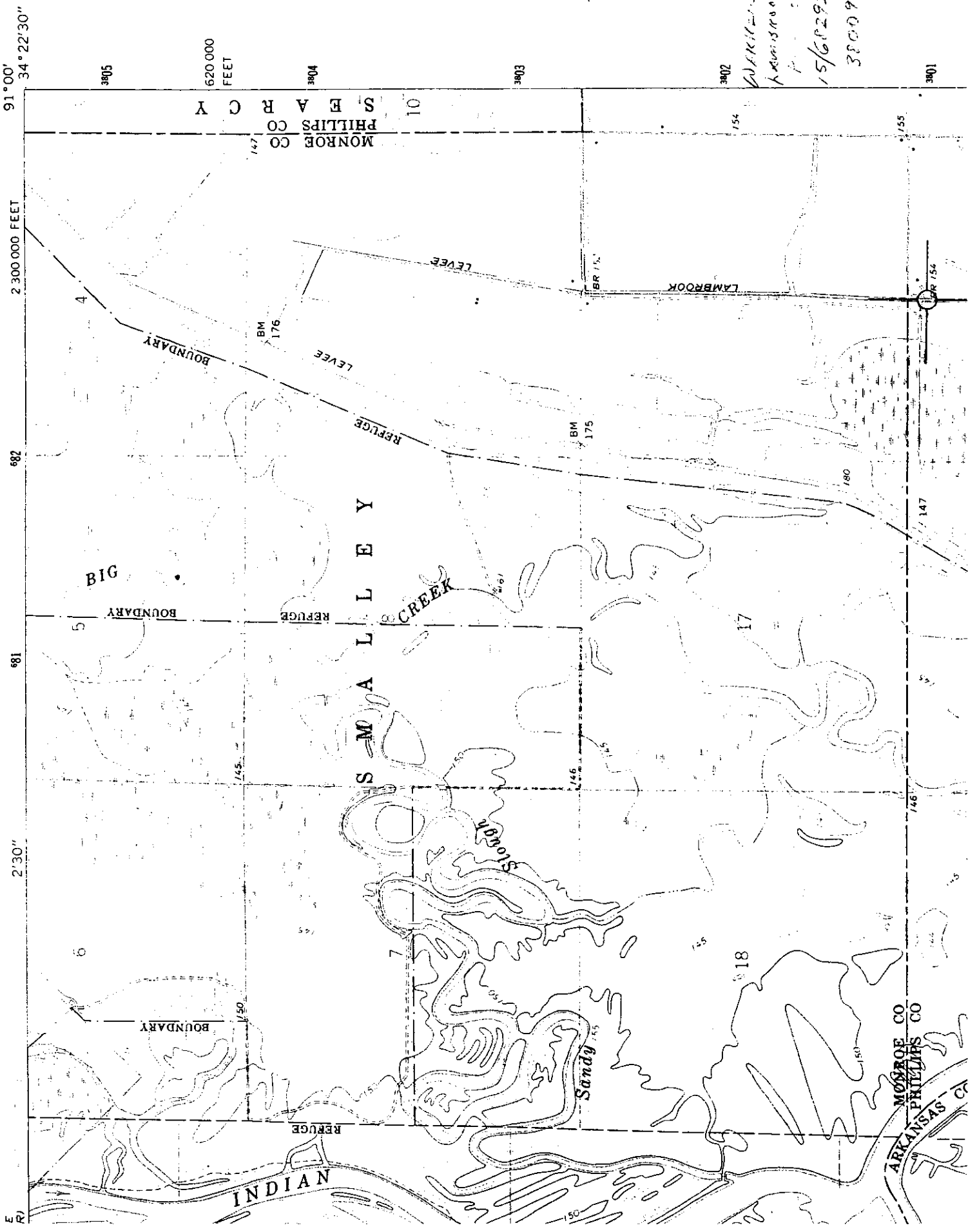

WALKER, B. D. JR.  
KANSAS CITY, MO.  
15/682920/  
3800900

7891  
MDDOC 11