

MT. ZION  
Sec. 15, 16, T 9 S, R 10 W

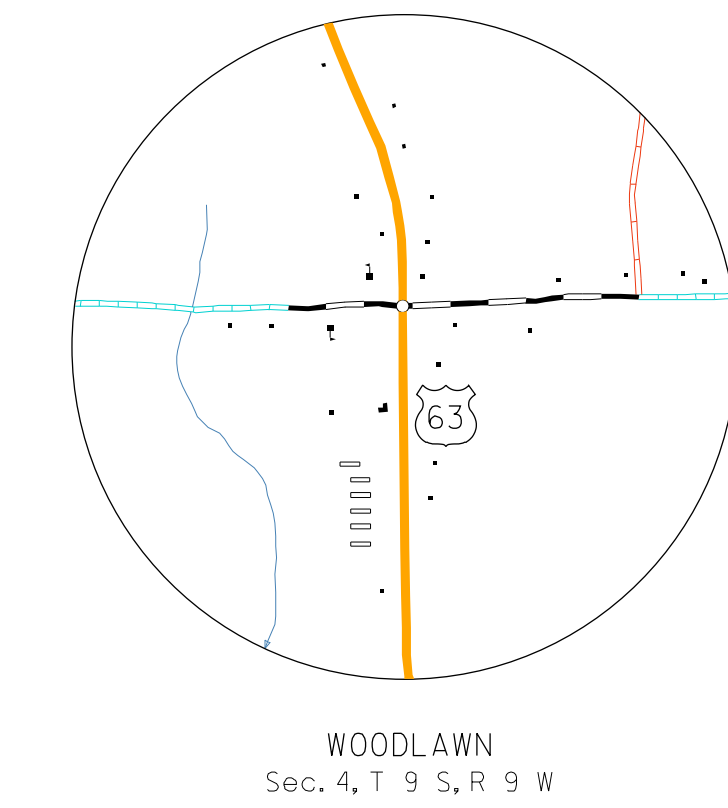

WOODLAWN  
Sec. 4, T 9 S, R 9 W

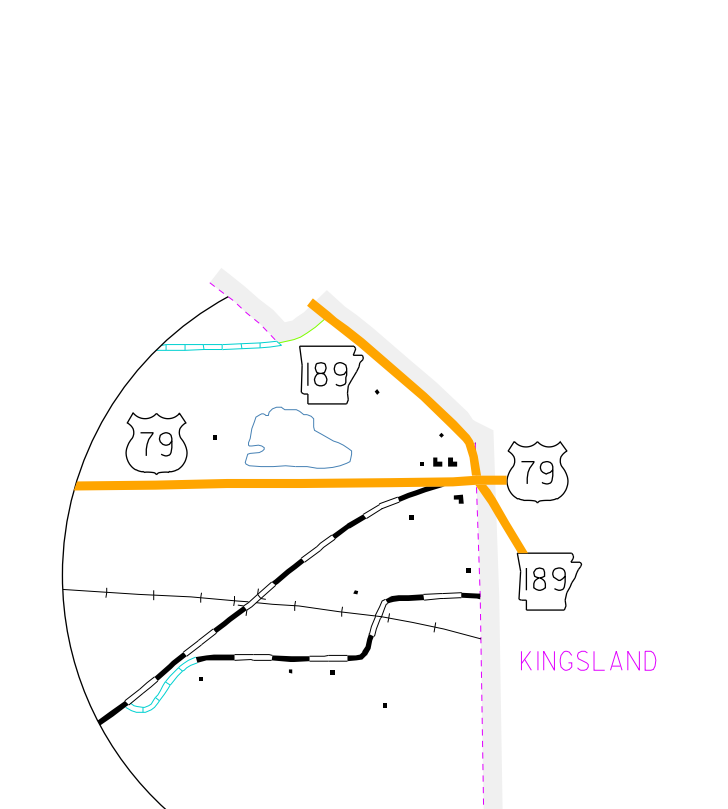

AREA WEST OF KINGSLAND  
Sec. 11, T 10 S, R 12 W

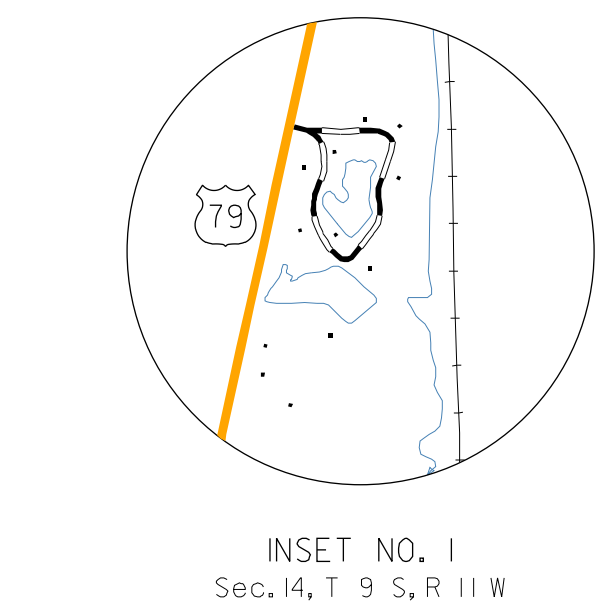

INSET NO. 1  
Sec. 14, T 9 S, R 11 W

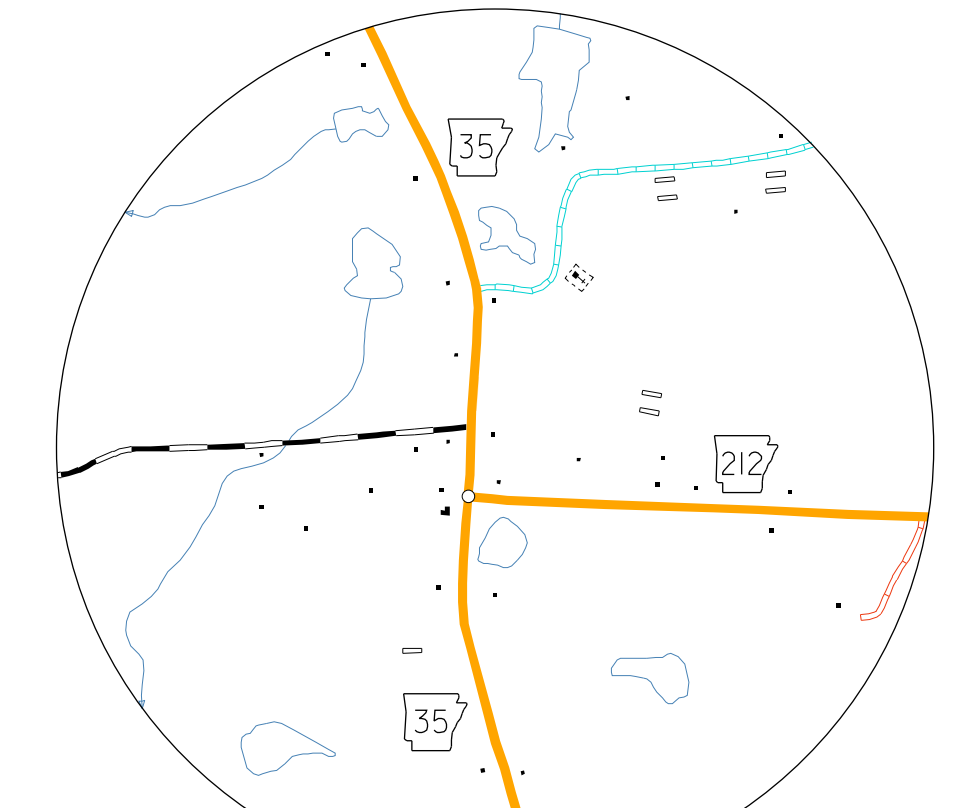

STAVES  
Sec. 12, T 8 S, R 12 W

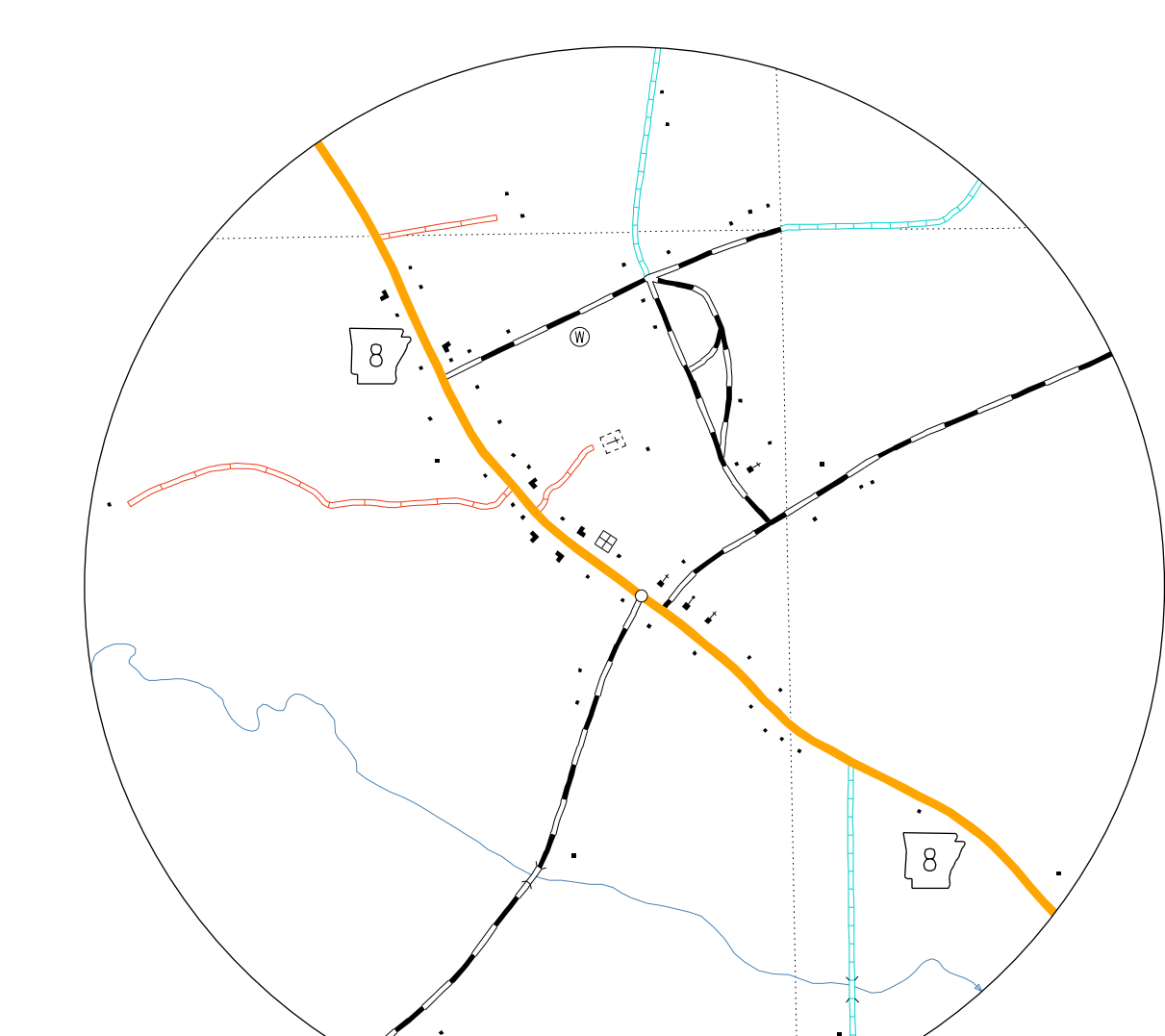

NEW EDINBURG  
Sec. 1, 10, 15, 16, T 11 S, R 11 W

- LEGEND
- COUNTY BOUNDARY
  - U.S. LAND TOWNSHIP LINE
  - SECTION LINE
  - PARK OR RESERVATION BOUNDARY
  - PAVED STATE OR U.S. HIGHWAY
  - U.S. NUMBERED HIGHWAY
  - STATE HIGHWAY
  - PAVED LOCAL ROAD
  - GRAVEL LOCAL ROAD
  - GRADED & DRAINED LOCAL ROAD
  - UNIMPROVED LOCAL ROAD
  - RAILROAD (ANY NUMBER OF TRACKS USED BY A SINGLE OPERATING COMPANY)
  - RAILROAD STATION
  - GRADE CROSSING
  - OVERPASS
  - UNDERPASS
  - HIGHWAY BRIDGE (50 FEET OR MORE IN LENGTH)
  - MILEAGE BETWEEN POINTS
  - LAKE, RESERVOIR OR POND
  - LAKE, RESERVOIR OR POND WITH DAM
  - MARSH OR SWAMP
  - WIDE RIVER OR STREAM
  - INTERMITTENT NAVIGATION
  - SMALL STREAM
  - DRAINAGE DITCH
  - CORPORATE LIMITS AND ROADS THROUGH TOWN
  - COUNTY SEAT
  - OTHER CITIES AND TOWNS
  - FARM UNIT OR DWELLING
  - GROUP OF CLOSELY SPACED DWELLINGS (4-4 TO 100 FEET SPACING)
  - CHURCH OR OTHER RELIGIOUS INSTITUTION
  - SCHOOL
  - POST OFFICE
  - POST OFFICE AND BUSINESS
  - CEMETERY
  - CHURCH WITH CEMETERY ADJACENT
  - BUSINESS ESTABLISHMENT
  - FACTORY OR INDUSTRIAL PLANT-COTTON OR
  - SAWMILL
  - GRAVEL PIT
  - QUARRY
  - NURSERY
  - TOWN OR COUNTY HALL
  - RADIO OR TELEVISION STATION AND CALL LETTERS
  - A.H.T.O. GARAGE OR COUNTY GARAGE
  - FIRE ENGINE HOUSE
  - POWER SUBSTATION
  - PUMPING STATION OIL OR GAS
  - HISTORICAL MONUMENT
  - CAMP OR LODGE
  - SMALL PARK (4-10 ACRES, EXCEPT FOR MARSHES, BEACHES, OR REST AREAS)
  - WATER SUPPLY STANDPIPE OR TANK
  - AUTO SALVAGE YARD
  - CHICKEN HOUSE OR OTHER LIVESTOCK

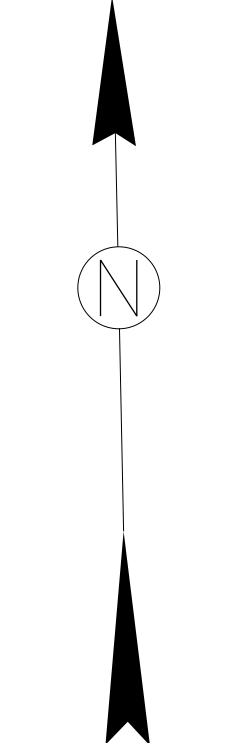

GENERAL HIGHWAY MAP  
**CLEVELAND COUNTY**  
ARKANSAS

PREPARED BY  
ARKANSAS STATE HIGHWAY AND TRANSPORTATION DEPARTMENT  
PLANNING AND RESEARCH DIVISION  
IN COOPERATION WITH  
U.S. DEPARTMENT OF TRANSPORTATION  
FEDERAL HIGHWAY ADMINISTRATION  
SCALE 1:62,500  
MILES

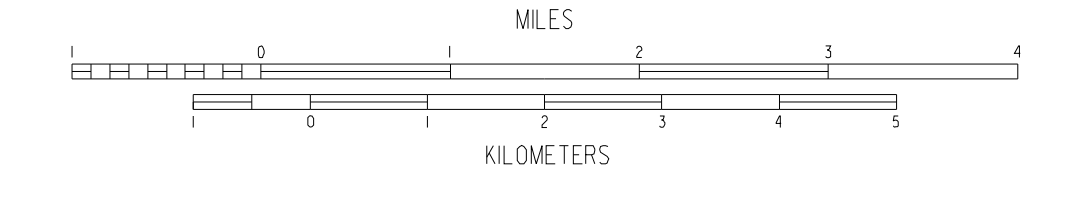

Copies of this map are available  
at a nominal fee from the  
Arkansas State Highway and  
Transportation Department,  
P.O. Box 2261 Little Rock, Ark. 72203

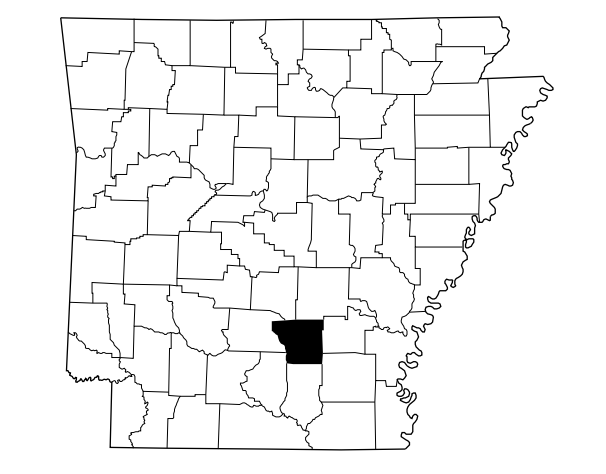

NOTE: Enlargements of all congested areas are five times  
map scale unless otherwise noted.  
Individual maps are available for all active incorporated cities.  
Area: 599 Square Miles  
Population: 437,000 Census  
Map Issued: 8-7-06 - replaces map issued 9-29-97  
File Inventory: 1916  
Map revisions made from aerial photographs taken 3-25-04  
Map compilation completed 5-10-06  
County map produced using Computer Assisted Cartography.