

INDEX

DAWSON CUTOFF C
 DENISON DR C-3
 E CASPER C-3
 GEURIN RD C-3
 HARDAWAY C-3
 LYNN C-3
 RAINWATER DR C-3
 SCHOOL C-3
 W SMITHVILLE RD C-3

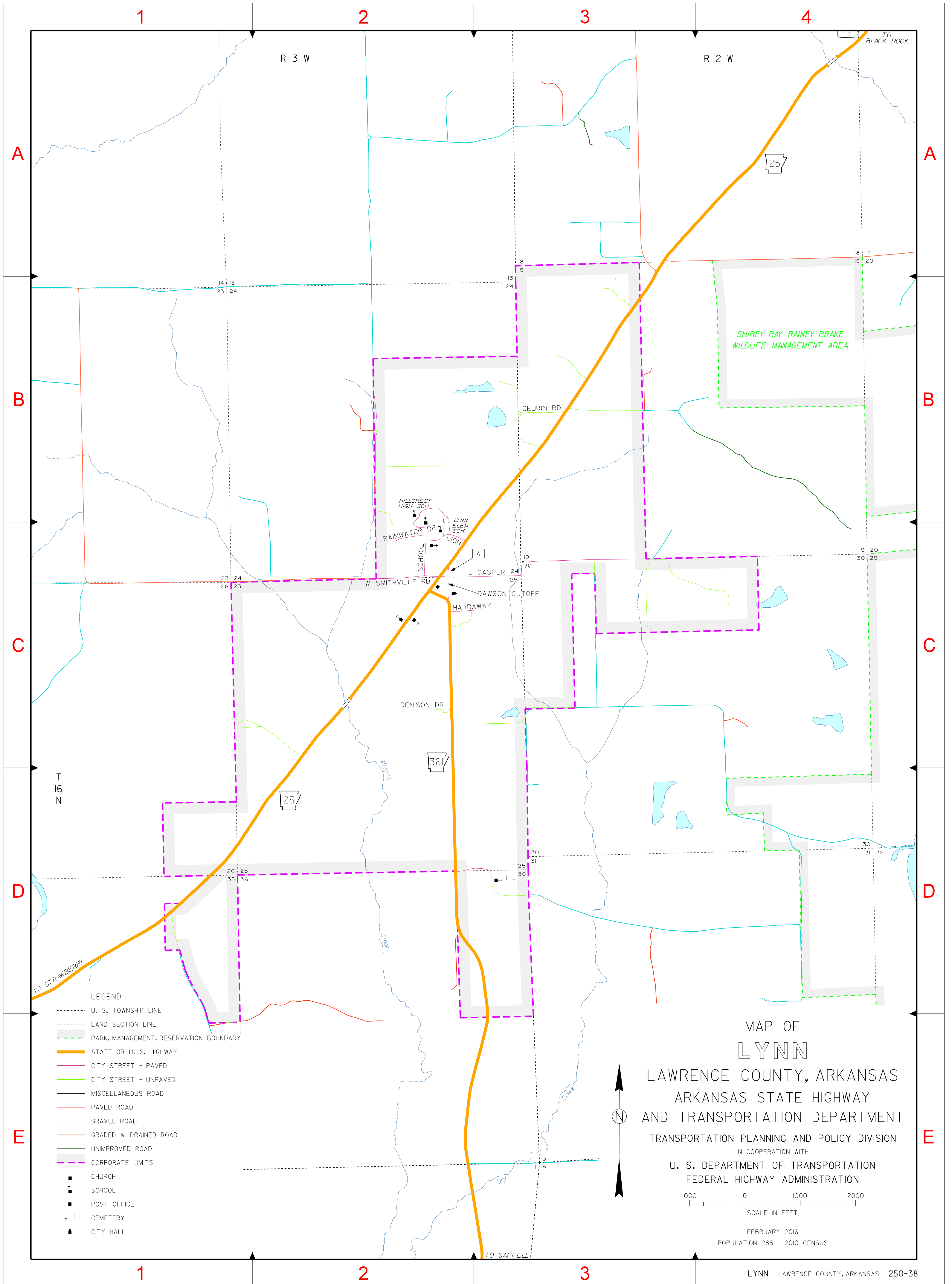

- LEGEND**
- U. S. TOWNSHIP LINE
 - LAND SECTION LINE
 - PARK, MANAGEMENT, RESERVATION BOUNDARY
 - STATE OR U. S. HIGHWAY
 - CITY STREET - PAVED
 - CITY STREET - UNPAVED
 - MISCELLANEOUS ROAD
 - PAVED ROAD
 - GRAVEL ROAD
 - GRADED & DRAINED ROAD
 - UNIMPROVED ROAD
 - CORPORATE LIMITS
 - † CHURCH
 - ▣ SCHOOL
 - POST OFFICE
 - † CEMETERY
 - ▲ CITY HALL

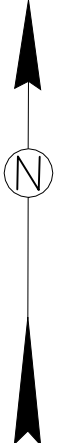

MAP OF
LYNN
 LAWRENCE COUNTY, ARKANSAS
 ARKANSAS STATE HIGHWAY
 AND TRANSPORTATION DEPARTMENT
 TRANSPORTATION PLANNING AND POLICY DIVISION
 IN COOPERATION WITH
 U. S. DEPARTMENT OF TRANSPORTATION
 FEDERAL HIGHWAY ADMINISTRATION



FEBRUARY 2016
 POPULATION 288 - 2010 CENSUS