

INDEX

- AMY LN
- ARKANSAS BLAKE RD
- BRENDA DR
- CARDINAL CT
- CARDOLYN RD
- CASEY LN
- CHARITY FAITH CT
- CHARLOTTE DR
- CHRISTEN LN
- DEERWOOD DR
- DEW DR
- DOC IRVIN DR
- DONNA DR
- E 3 RD
- E 7 TH
- E CENTER
- E CHURCH
- E GUM
- E HIGH
- E HOLLY
- E MOCKINGBIRD LN
- E PINE
- E SUNSET DR
- EDGEWOOD DR
- ELANE RD
- ELM
- FIGER DR
- FRANK CLARK RD
- FRANK CLARK RD
- FREDA LN
- GARY LN
- GATES DR
- GATZKE DR
- GERI LN
- HAZELWOOD DR
- HILL LN
- HOPKINS LN
- HOPWELL DR
- HORTON HILLS DR
- JACKSON LN
- JANIS DR
- JOHNSON LN
- JONES DR
- JULIA DR
- KATHY LN
- KODJ
- LEF TYLER DR
- LITTLE CREEK CUT OFF RD
- LONGELL DR
- N ARCH
- N ARCH
- N ASH
- N BIRCHWOOD DR
- N CLIFF
- N CLIFF
- N COLLEGE
- N CUMBERLAND
- N EAGLE
- N GRANT
- N MAIN
- N MARION
- N MARION
- N OAK
- N RED
- N RED
- N ROCK
- N ROSE
- N ROSE
- N SPRING
- OKLAHOMA
- OAKWOOD DR
- OLEN LN
- OFFSPRING DR
- PARK TR
- PHILIP DR
- PHILLIPS
- PHILIP DR
- PINE BLUFF DR
- PINECREST CR
- RANSLOW LN
- REYNOLDS DR
- ROBE DR
- RIDGEWAY DR
- ROBIN DR
- ROBIN LN
- ROCK CT
- S ARCH
- S BIRCHWOOD DR
- S CUMBERLAND
- S EAGLE
- S GRANT
- S MAIN
- S OAK
- S OKLAHOMA
- S RED
- S ROCK
- S ROSE
- S SPRING
- SCOTT
- SCOTT
- SHANNON LN
- SHOEMAKER DR
- SHORT
- SITES DR
- S KORKC
- S KYLINE DR
- SOUTHERLAND CT
- SOUTHLAND DR
- SPRAY DR
- STEPHANE LN
- STEPHENSON LP
- STEVENS DR
- SUMMIT
- SYLVIA DR
- TOLER
- VALLEY CT
- VILLAGE LN
- W 3 TH
- W 4 TH
- W 5 TH
- W 6 TH
- W 7 TH
- W 8 TH
- W 9 TH
- W CENTER
- W CHURCH
- W GUM
- W HIGH
- W HOLLY
- W JOHNSON
- W MOCKINGBIRD LN
- W PINE
- W SUNSET DR
- W VINE DR
- WENDY DR
- WHIPPOORWILL DR
- WHITE OAK DR
- WILLIAM CT
- WILLIAM WAY
- WILLIAMS DR
- WILLOW
- WINSTON DR
- WOODEN HEAD LN

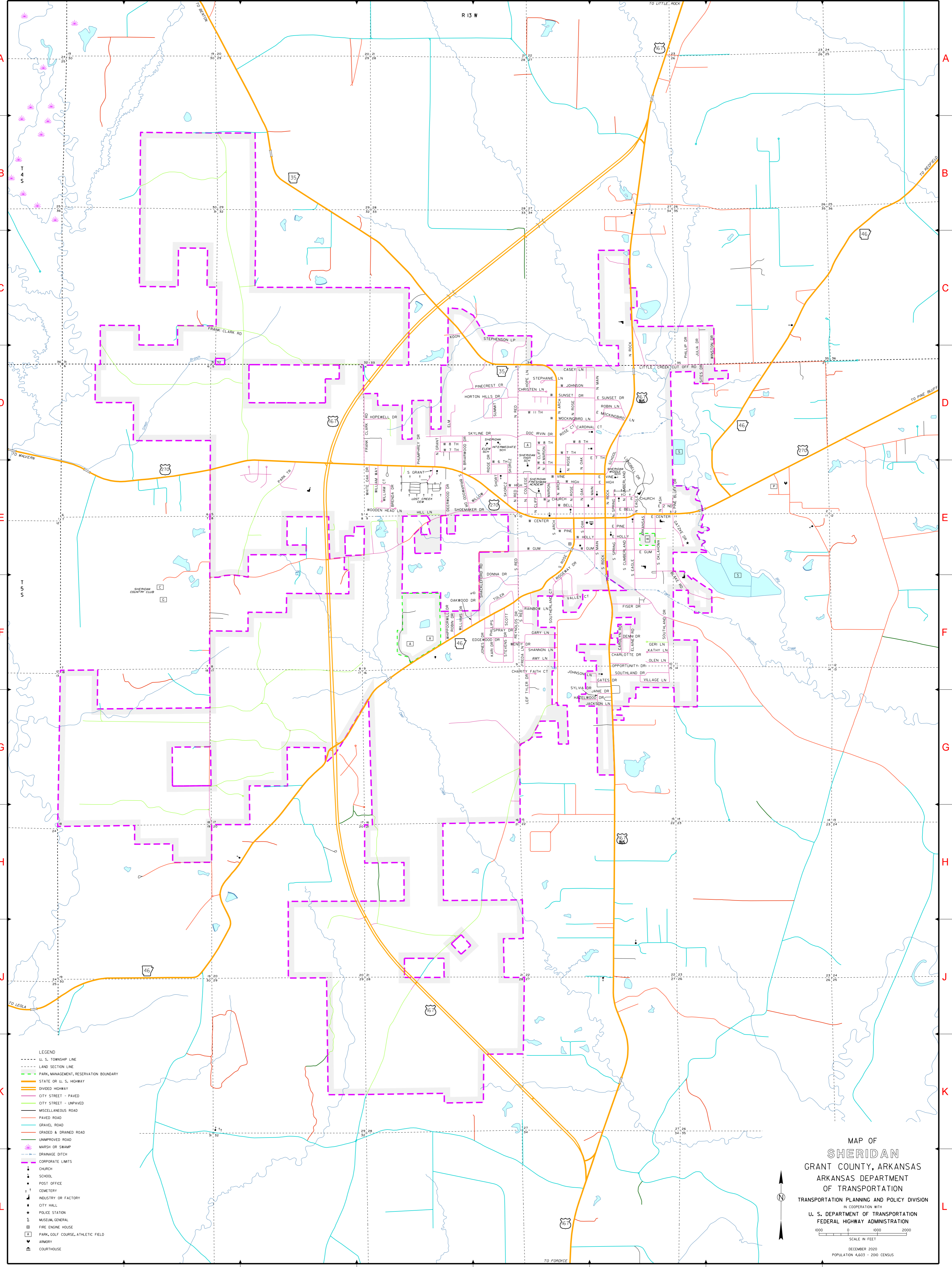

A
B
C
D
E
F
G
H
J
K
L

- LEGEND
- U. S. TOWNSHIP LINE
 - LAND SECTION LINE
 - PARK, MANAGEMENT, RESERVATION BOUNDARY
 - STATE OR U. S. HIGHWAY
 - DIVIDED HIGHWAY
 - CITY STREET - PAVED
 - CITY STREET - UNPAVED
 - MISCELLANEOUS ROAD
 - PAVED ROAD
 - GRAVEL ROAD
 - GRADED & DRAINED ROAD
 - UNIMPROVED ROAD
 - MARSH OR SWAMP
 - DRAINAGE DITCH
 - CORPORATE LIMITS
 - CHURCH
 - SCHOOL
 - POST OFFICE
 - CEMETERY
 - INDUSTRY OR FACTORY
 - CITY HALL
 - POLICE STATION
 - MUSEUM, GENERAL
 - FIRE ENGINE HOUSE
 - PARK, GOLF COURSE, ATHLETIC FIELD
 - ARMORY
 - COURTHOUSE

MAP OF
SHERIDAN
 GRANT COUNTY, ARKANSAS
 ARKANSAS DEPARTMENT
 OF TRANSPORTATION
 TRANSPORTATION PLANNING AND POLICY DIVISION
 IN COOPERATION WITH
 U. S. DEPARTMENT OF TRANSPORTATION
 FEDERAL HIGHWAY ADMINISTRATION

1000 0 1000 2000
 SCALE IN FEET
 DECEMBER 2020
 POPULATION 4,603 - 2010 CENSUS

SHERIDAN GRANT COUNTY, ARKANSAS 250-27