

# INDEX

BALL PARK RD  
 CEDAR LN  
 E HUBBARD RD  
 E PINE  
 E RIVER DR  
 E WHEEL  
 JERUSALEM RD  
 LONE HILL DR  
 MAPLE  
 N MAIN  
 N WALNUT  
 OAK  
 S MAIN  
 S PENN  
 SHADY LN  
 TURNER DR  
 W RIVER DR  
 WOODS

B-2  
 B-3  
 A-4  
 B-3  
 B-3  
 B-3  
 B-3  
 B-3  
 B-3  
 B-3  
 C-3  
 B-3  
 B-3  
 B-3  
 B-3  
 B-3  
 B-2  
 B-3

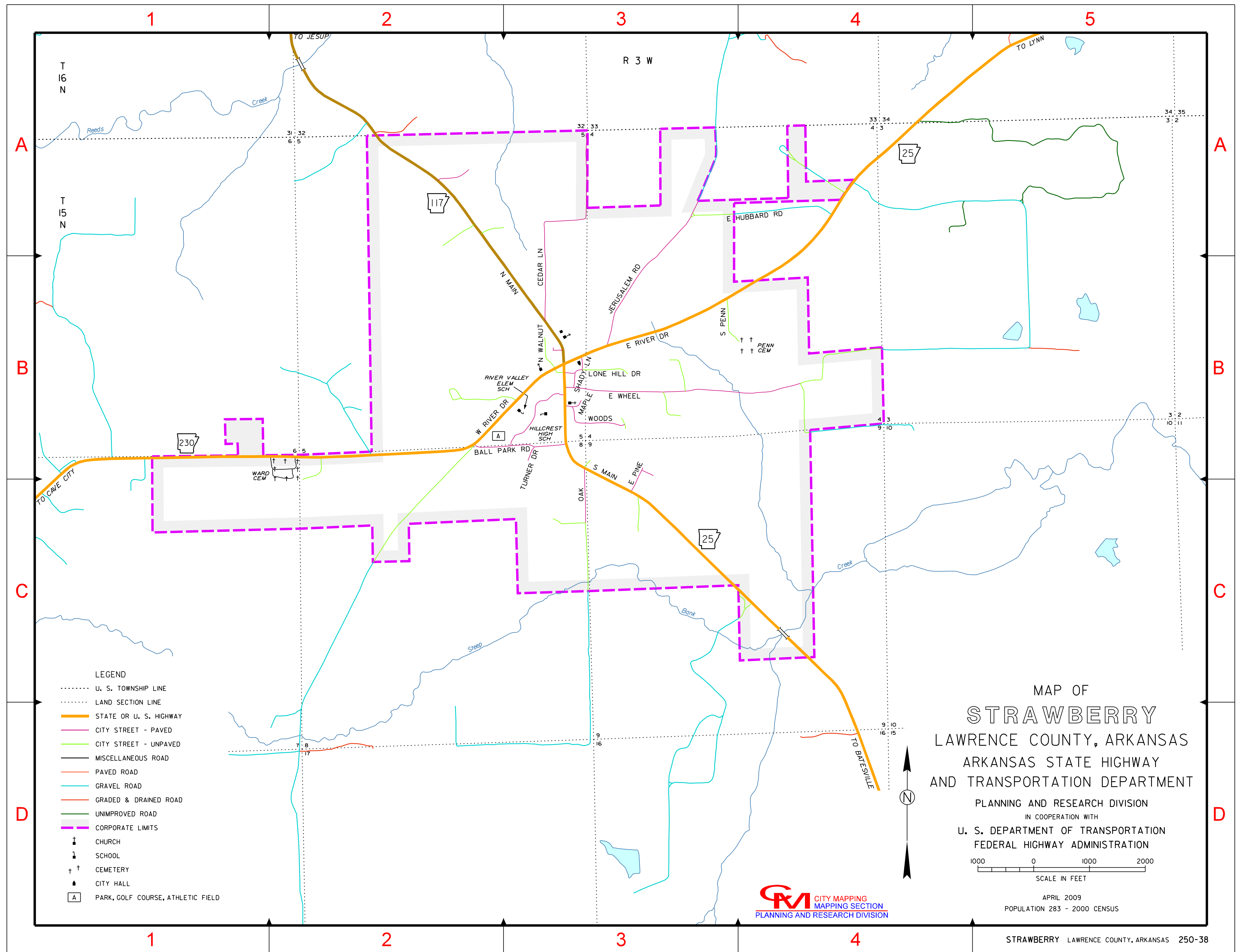

- LEGEND**
- ..... U. S. TOWNSHIP LINE
  - ..... LAND SECTION LINE
  - STATE OR U. S. HIGHWAY
  - CITY STREET - PAVED
  - CITY STREET - UNPAVED
  - MISCELLANEOUS ROAD
  - PAVED ROAD
  - GRAVEL ROAD
  - GRADED & DRAINED ROAD
  - UNIMPROVED ROAD
  - CORPORATE LIMITS
  - ⊕ CHURCH
  - ⊓ SCHOOL
  - † † CEMETERY
  - ⚡ CITY HALL
  - ⓐ PARK, GOLF COURSE, ATHLETIC FIELD

MAP OF  
**STRAWBERRY**  
 LAWRENCE COUNTY, ARKANSAS  
 ARKANSAS STATE HIGHWAY  
 AND TRANSPORTATION DEPARTMENT

PLANNING AND RESEARCH DIVISION  
 IN COOPERATION WITH  
 U. S. DEPARTMENT OF TRANSPORTATION  
 FEDERAL HIGHWAY ADMINISTRATION

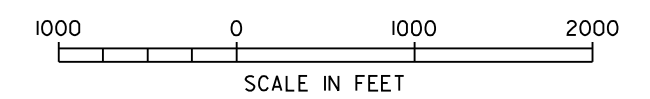

APRIL 2009  
 POPULATION 283 - 2000 CENSUS

