

INDEX

ADAMS	A-2
APPLE	A-2
E MAIN	A-2
E ROOSEVELT	A-2
E WASHINGTON	A-2
GUM	A-2
JACKSON	A-2
JEFFERSON	B-2
N BIRCH	A-2
N CEDAR	A-2
N DOGWOOD	A-2
N FIR	A-2
S BIRCH	B-2
S CEDAR	B-2
S DOGWOOD	B-2
S FIR	B-2
W MAIN	B-2
W ROOSEVELT	A-2
W WASHINGTON	A-2

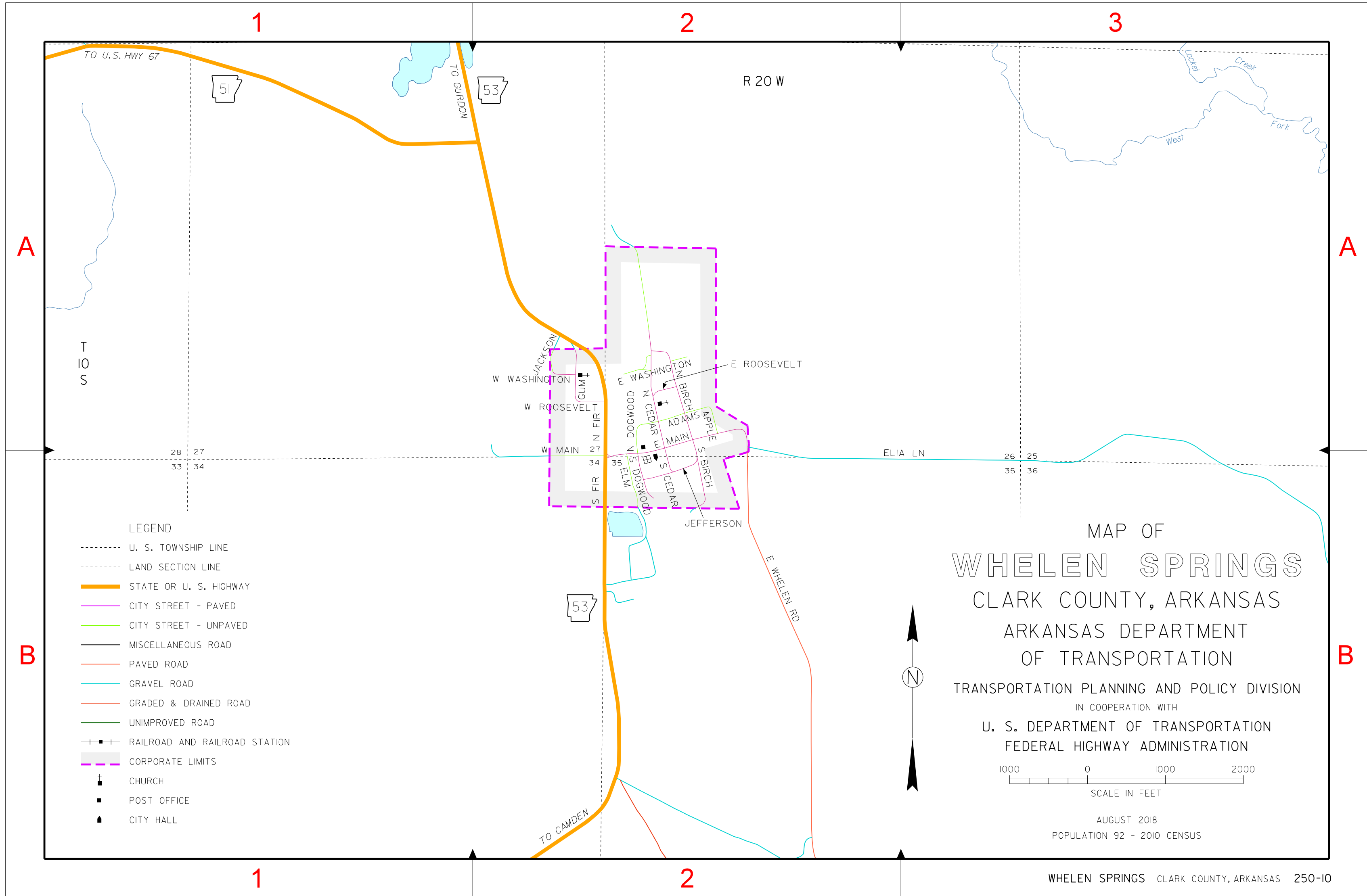

LEGEND

- U. S. TOWNSHIP LINE
- LAND SECTION LINE
- STATE OR U. S. HIGHWAY
- CITY STREET - PAVED
- CITY STREET - UNPAVED
- MISCELLANEOUS ROAD
- PAVED ROAD
- GRAVEL ROAD
- GRADED & DRAINED ROAD
- UNIMPROVED ROAD
- RAILROAD AND RAILROAD STATION
- CORPORATE LIMITS
- CHURCH
- POST OFFICE
- CITY HALL

MAP OF
WHELEN SPRINGS
 CLARK COUNTY, ARKANSAS
 ARKANSAS DEPARTMENT
 OF TRANSPORTATION

TRANSPORTATION PLANNING AND POLICY DIVISION
 IN COOPERATION WITH
 U. S. DEPARTMENT OF TRANSPORTATION
 FEDERAL HIGHWAY ADMINISTRATION



AUGUST 2018
 POPULATION 92 - 2010 CENSUS