

INDEX

AVALON	A-2
CAPITOL	A-2
DELTA QUEEN AVE	A-2
DELTA QUEEN AVE	B-2
DESOTA AVE	B-2
GEORGIE LEE AVE	A-2
HAGOOD DR	B-2
J B PAYNE DR	A-2
J B PAYNE DR	B-2
KATE ADAMS AVE	A-2
LINDA	B-2
MANGUM DR	A-2
MARIAN	A-3
MEMPHIS	A-2
MORNING STAR AVE	A-2
NATCHEZ	A-2
PARK	A-2
PRESIDENT	A-2
R C BIXLER DR	B-2
REITZAMMER DR	A-3
ROBERT S MOORE AVE	A-2
SADIE LEE AVE	A-2
SCHOOL DR	A-2
SCHOOL DR	B-2
SPRAGUE	B-2
TULAGI	B-2
WEATHERWOOD	B-2
WHITE HILL RD	A-2

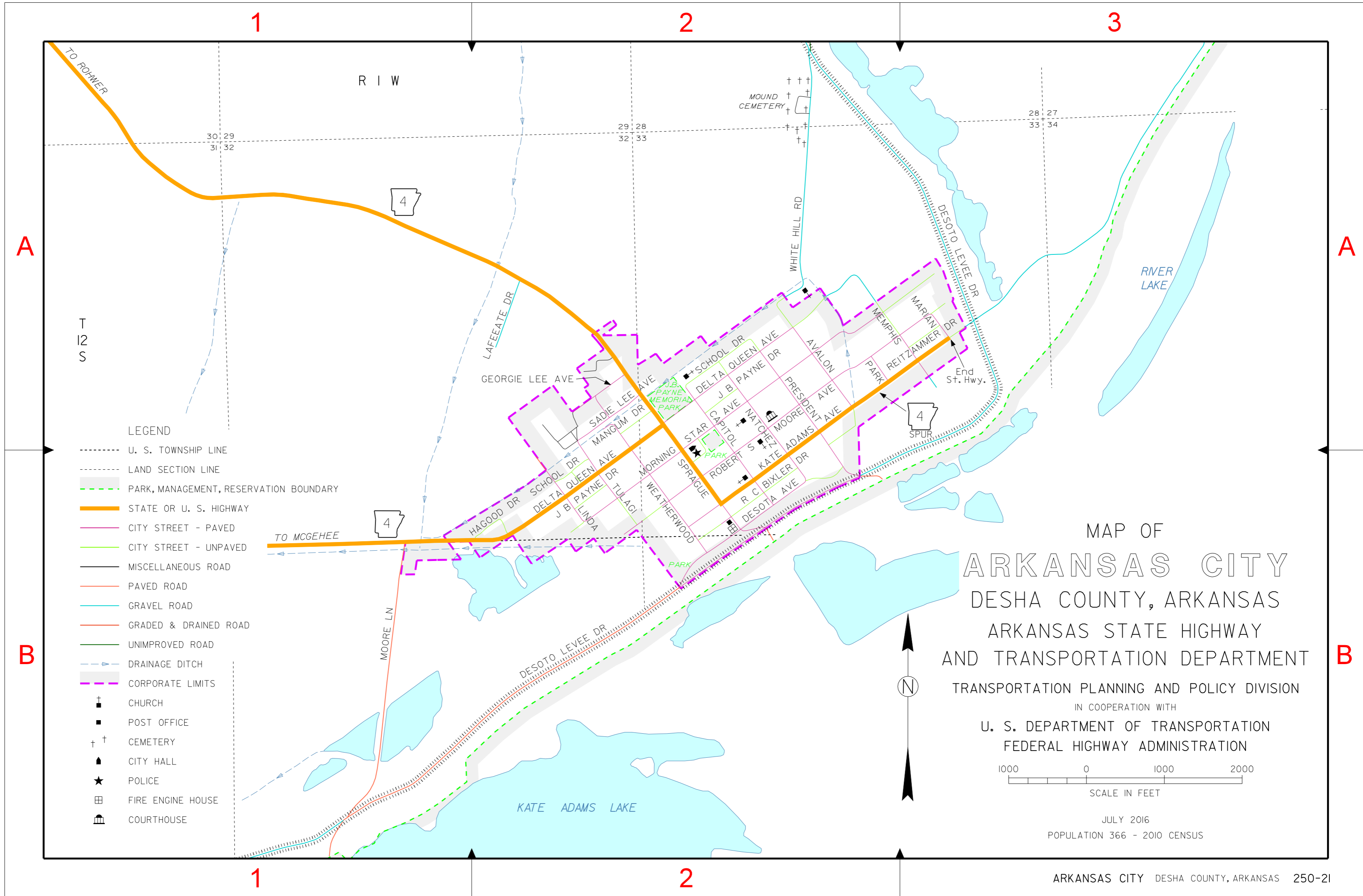

- LEGEND**
- U. S. TOWNSHIP LINE
 - LAND SECTION LINE
 - - - - - PARK, MANAGEMENT, RESERVATION BOUNDARY
 - STATE OR U. S. HIGHWAY
 - CITY STREET - PAVED
 - CITY STREET - UNPAVED
 - MISCELLANEOUS ROAD
 - PAVED ROAD
 - GRAVEL ROAD
 - GRADED & DRAINED ROAD
 - UNIMPROVED ROAD
 - DRAINAGE DITCH
 - CORPORATE LIMITS
 - † CHURCH
 - POST OFFICE
 - † † CEMETERY
 - ▲ CITY HALL
 - ★ POLICE
 - ▣ FIRE ENGINE HOUSE
 - ▤ COURTHOUSE

MAP OF
ARKANSAS CITY
 DESHA COUNTY, ARKANSAS
 ARKANSAS STATE HIGHWAY
 AND TRANSPORTATION DEPARTMENT
 TRANSPORTATION PLANNING AND POLICY DIVISION
 IN COOPERATION WITH
 U. S. DEPARTMENT OF TRANSPORTATION
 FEDERAL HIGHWAY ADMINISTRATION

1000 0 1000 2000
 SCALE IN FEET

JULY 2016
 POPULATION 366 - 2010 CENSUS