

INDEX

1 ST	B-2
2 ND	A-2
3 RD	A-2
5 TH W	A-2
6 TH W	A-2
BERTHA	A-2
BROADWAY N	A-2
BROADWAY S	A-2
CASA-ALPIN RD	B-3
CHERRY N	A-2
CHERRY S	A-2
FOURCHE	A-2
LOCUST S	A-2
MAIN N	A-2
MAPLE N	A-2
MAPLE S	A-2
RAILROAD AVE	A-2
TOWER RD	B-2
WALNUT N	A-2

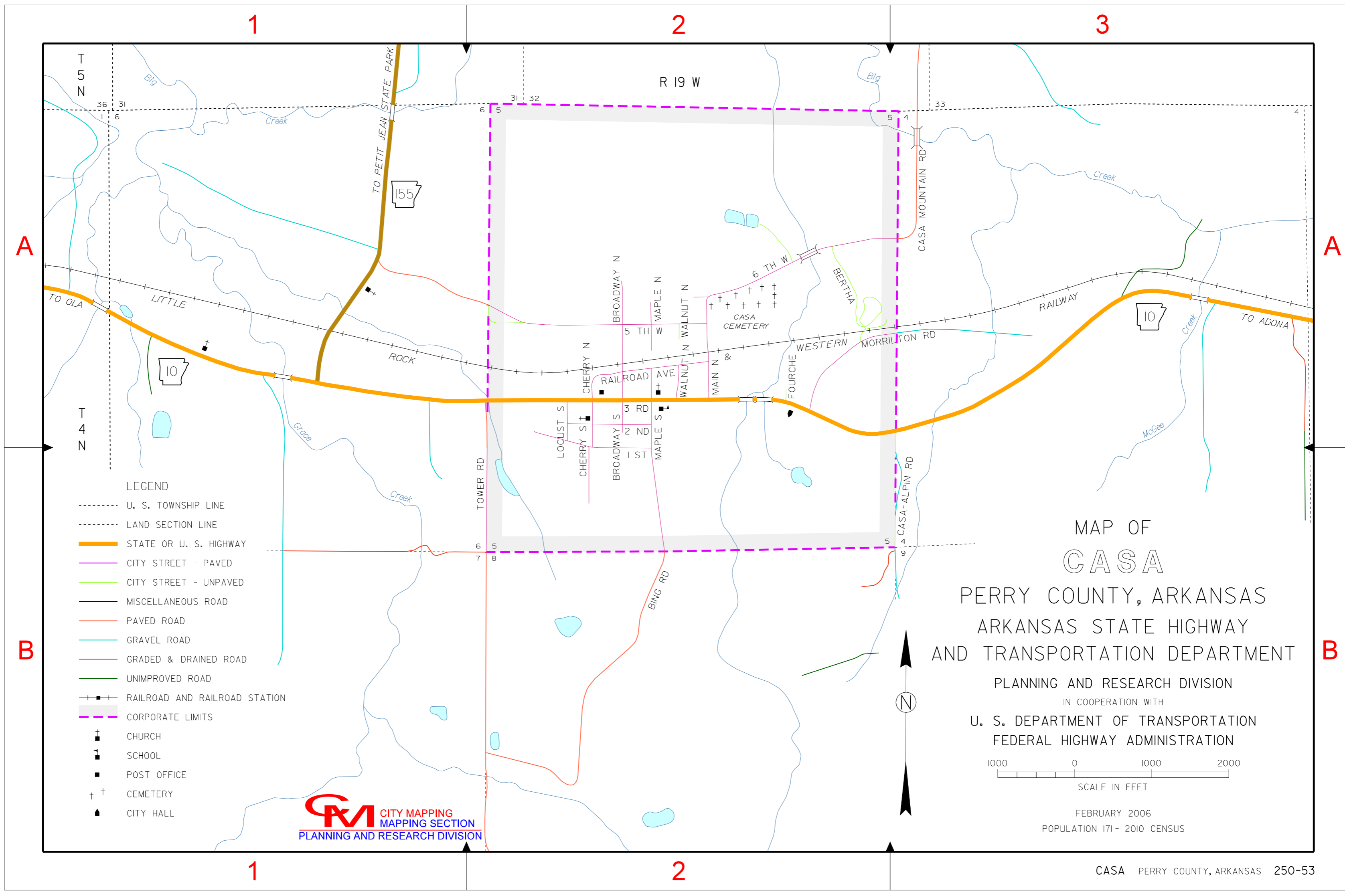

- LEGEND**
- U. S. TOWNSHIP LINE
 - LAND SECTION LINE
 - STATE OR U. S. HIGHWAY
 - CITY STREET - PAVED
 - CITY STREET - UNPAVED
 - MISCELLANEOUS ROAD
 - PAVED ROAD
 - GRAVEL ROAD
 - GRADED & DRAINED ROAD
 - UNIMPROVED ROAD
 - RAILROAD AND RAILROAD STATION
 - CORPORATE LIMITS
 - † CHURCH
 - ▣ SCHOOL
 - ▣ POST OFFICE
 - † CEMETERY
 - ▲ CITY HALL

MAP OF
CASA
PERRY COUNTY, ARKANSAS
ARKANSAS STATE HIGHWAY
AND TRANSPORTATION DEPARTMENT

PLANNING AND RESEARCH DIVISION
IN COOPERATION WITH
U. S. DEPARTMENT OF TRANSPORTATION
FEDERAL HIGHWAY ADMINISTRATION



FEBRUARY 2006
POPULATION 171 - 2010 CENSUS

