

INDEX

- 2 ND
- 3 TH
- 4 TH
- 5 TH
- 6 TH
- 7 TH
- 8 TH
- 9 TH
- 10 TH
- 11 TH
- 12 TH
- ALABAMA
- ALLEY
- ARBAUGH AVE
- ARKANSAS
- ARMS TRONG
- BASKIN
- BELL
- BLAKELY
- BURLISON
- BUSTER
- CAROLINA
- CEDAR
- CEMETERY
- CHERRY
- COLLEGE
- COLLIER
- CONDIT BLVD
- DORNEY
- DOSS
- ELM
- GEORGIA
- HARRIS
- HARRIS
- HARTMAN OLD HWY 64
- HILLTOP RD
- HORMON
- JAMES
- KINNEY
- LEE
- LINE
- LINE
- MAIN
- MAPLE
- MONROE
- MULDON LN
- N CIRCLE DR
- OAK
- OBERSTE
- PERSIMMON
- PINE
- PLUGGE
- POYNER
- PRUETT
- QUAIL
- RABBIT HILL RD
- RAILROAD
- RAILROAD
- REYNOLDS
- RIVER
- S CIRCLE DR
- SCHOOL
- SHORT
- SPRING
- STALLINGS
- STEPHENS
- STOUFFER
- THOMPSON
- WOFFORD
- YEAGER

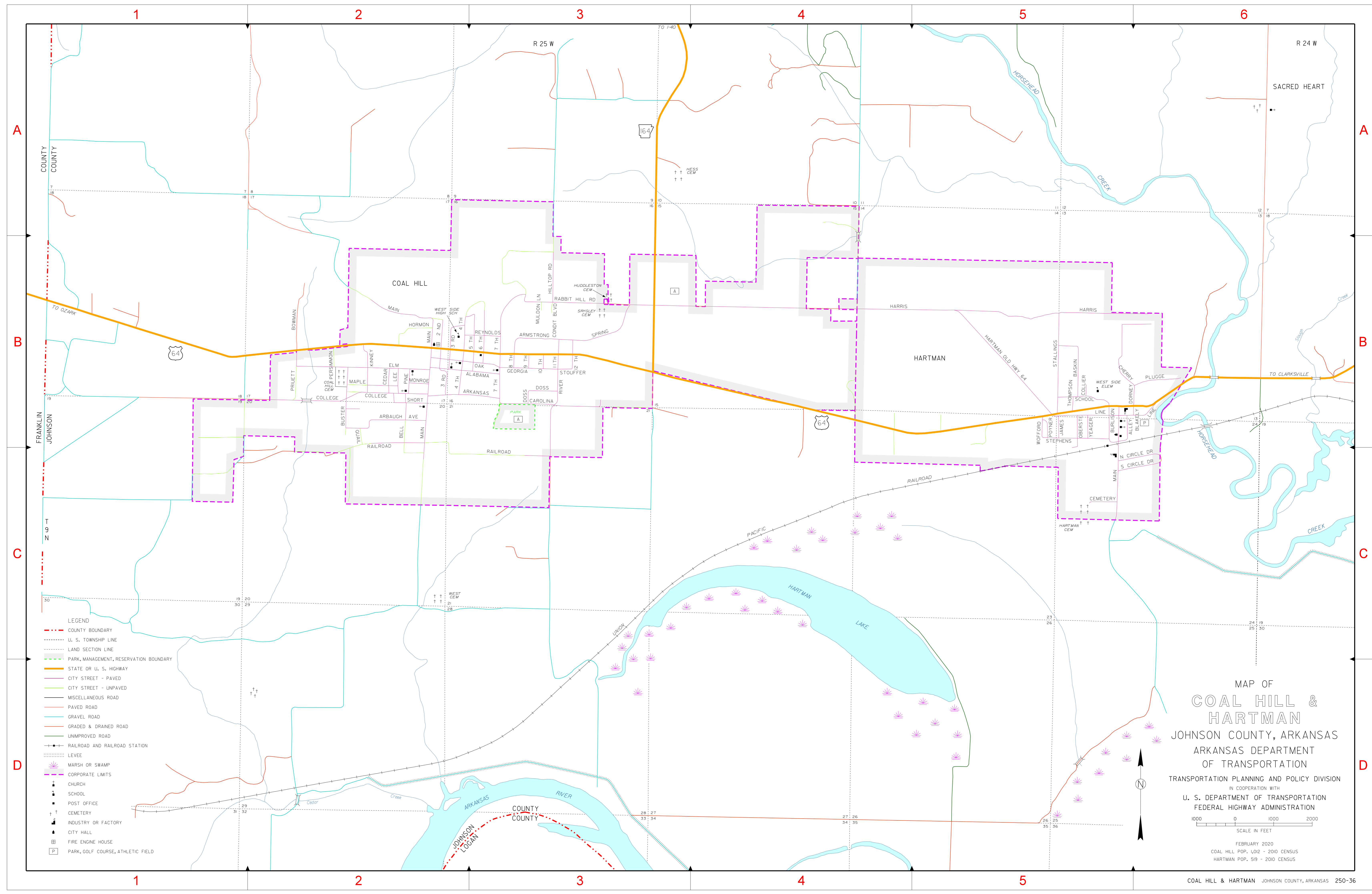

- LEGEND
- COUNTY BOUNDARY
 - U. S. TOWNSHIP LINE
 - LAND SECTION LINE
 - PARK, MANAGEMENT, RESERVATION BOUNDARY
 - STATE OR U. S. HIGHWAY
 - CITY STREET - PAVED
 - CITY STREET - UNPAVED
 - MISCELLANEOUS ROAD
 - PAVED ROAD
 - GRAVEL ROAD
 - GRADED & DRAINED ROAD
 - UNIMPROVED ROAD
 - RAILROAD AND RAILROAD STATION
 - LEVEE
 - MARSH OR SWAMP
 - CORPORATE LIMITS
 - CHURCH
 - SCHOOL
 - POST OFFICE
 - CEMETERY
 - INDUSTRY OR FACTORY
 - CITY HALL
 - FIRE ENGINE HOUSE
 - PARK, GOLF COURSE, ATHLETIC FIELD

MAP OF
COAL HILL & HARTMAN
 JOHNSON COUNTY, ARKANSAS
 ARKANSAS DEPARTMENT
 OF TRANSPORTATION
 TRANSPORTATION PLANNING AND POLICY DIVISION
 IN COOPERATION WITH
 U. S. DEPARTMENT OF TRANSPORTATION
 FEDERAL HIGHWAY ADMINISTRATION

1000 0 1000 2000
 SCALE IN FEET

FEBRUARY 2020
 COAL HILL POP. 1,012 - 2010 CENSUS
 HARTMAN POP. 519 - 2010 CENSUS

COAL HILL & HARTMAN JOHNSON COUNTY, ARKANSAS 250-36