

INDEX

5 TH	D-5
ADAM	D-5
ARLIE	D-5
ARNOLD	D-5
ARNOLD RD	C-4
BARTON	C-5
BASIL	D-5
BOBCAT LN	D-5
BRYAN	D-5
BRYAN AVE	C-5
CALLOWAY	C-4
CHERRY	C-4
CHESTNUT	D-5
COCHRAN	D-5
COLLINS RD	D-7
COLUMBIA	D-5
CRAWFORD	C-5
CREASON RD	B-4
DAVID	B-5
E 2 ND	C-6
E 3 RD	D-6
ELM	D-6
FIRST	C-6
HAZEL	C-6
LAUREL	C-6
MAIN	C-6
WALNUT	C-6
EATON	D-5
EDITH	C-5
ELM	C-5
FERGUSON RD	D-7
GARLAND	C-5
GEORGE	C-6
GREGORY	C-4
GRIGGS LN	C-4
HARPER	C-4
HAZEL	C-5
HOPE	C-5
HOSPITAL DR	B-5
INDUSTRIAL DR	B-6
IRMA	C-5
JILL LN	C-5
JONES	C-5
KELL	C-4
KELWIN	C-4
KENMORE	C-5
KIPPER LN	C-5
LAUREL	C-5
LEE	C-5
LINCOLN AVE	C-4
LOCKWOOD DR	D-4
LOCUST	C-5
LOGAN LN	D-6
LUCIEN	D-5
LUCIEN AVE	D-5
MADDOX	C-5
MAGNOLIA	C-5
MANATT DR	D-6
MARK	B-5
MARKET	D-5
MARTIN LN	D-6
MCKINLEY AVE	C-5
MILLS AVE	C-5
MISSOURI AVE	C-4
OAK	C-4
OVERDENE	C-4
OWENS	C-4
PARK	C-5
PHILIPS	C-4
PLAINVIEW	C-4
POLK AVE	D-5
SAND AVE	D-5
SARA	C-6
SCOTT	B-5
SHARON	C-5
SMITH	C-4
STEPHEN	C-4
SUCCESS	C-5
THERESA	C-4
VICTORIA	C-4
W 2 ND	D-6
W 3 RD	C-6
W 4 TH	C-6
W 5 TH	C-6
W 6 TH	C-6
W 9 TH AVE	C-5
W 10 TH AVE	D-5
W 11 TH	D-5
W ELM	C-5
W FIRST	D-6
W MAIN	C-5
W OLIVE	D-5
W PINE	C-5
W VINE	C-5
W WALNUT	C-6
WARDELL	C-5
WASHINGTON	C-5
WOOTEN	C-6

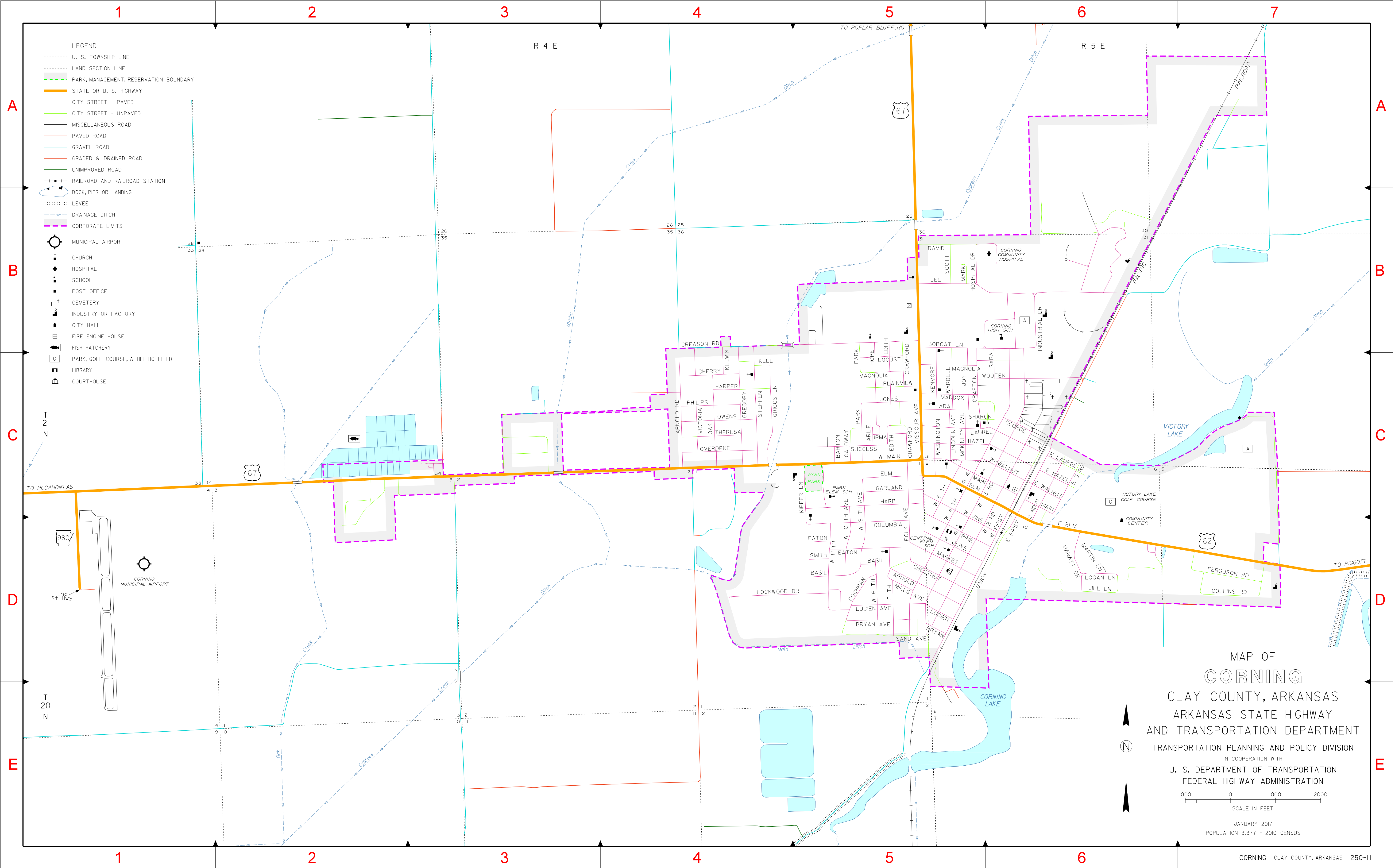

- LEGEND**
- U. S. TOWNSHIP LINE
 - LAND SECTION LINE
 - PARK, MANAGEMENT, RESERVATION BOUNDARY
 - STATE OR U. S. HIGHWAY
 - CITY STREET - PAVED
 - CITY STREET - UNPAVED
 - MISCELLANEOUS ROAD
 - PAVED ROAD
 - GRAVEL ROAD
 - GRADED & DRAINED ROAD
 - UNIMPROVED ROAD
 - RAILROAD AND RAILROAD STATION
 - DOCK, PIER OR LANDING
 - LEVEE
 - DRAINAGE DITCH
 - CORPORATE LIMITS
 - MUNICIPAL AIRPORT
 - CHURCH
 - HOSPITAL
 - SCHOOL
 - POST OFFICE
 - CEMETERY
 - INDUSTRY OR FACTORY
 - CITY HALL
 - FIRE ENGINE HOUSE
 - FISH HATCHERY
 - PARK, GOLF COURSE, ATHLETIC FIELD
 - LIBRARY
 - COURTHOUSE

MAP OF
CORNING
 CLAY COUNTY, ARKANSAS
 ARKANSAS STATE HIGHWAY
 AND TRANSPORTATION DEPARTMENT
 TRANSPORTATION PLANNING AND POLICY DIVISION
 IN COOPERATION WITH
 U. S. DEPARTMENT OF TRANSPORTATION
 FEDERAL HIGHWAY ADMINISTRATION

1000 0 1000 2000
 SCALE IN FEET

JANUARY 2017
 POPULATION 3,377 - 2010 CENSUS