

# INDEX

- CHARLES
- CLAY COUNTY 110 RD
- DELMAR
- EARL
- FIFTH
- FIRST
- FOURTH
- LEE
- LOREN
- RUSSELL
- SECOND
- THIRD

- B-2
- A-2
- B-2
- B-2
- A-2
- B-2
- B-2
- B-2
- B-2
- B-2
- B-2

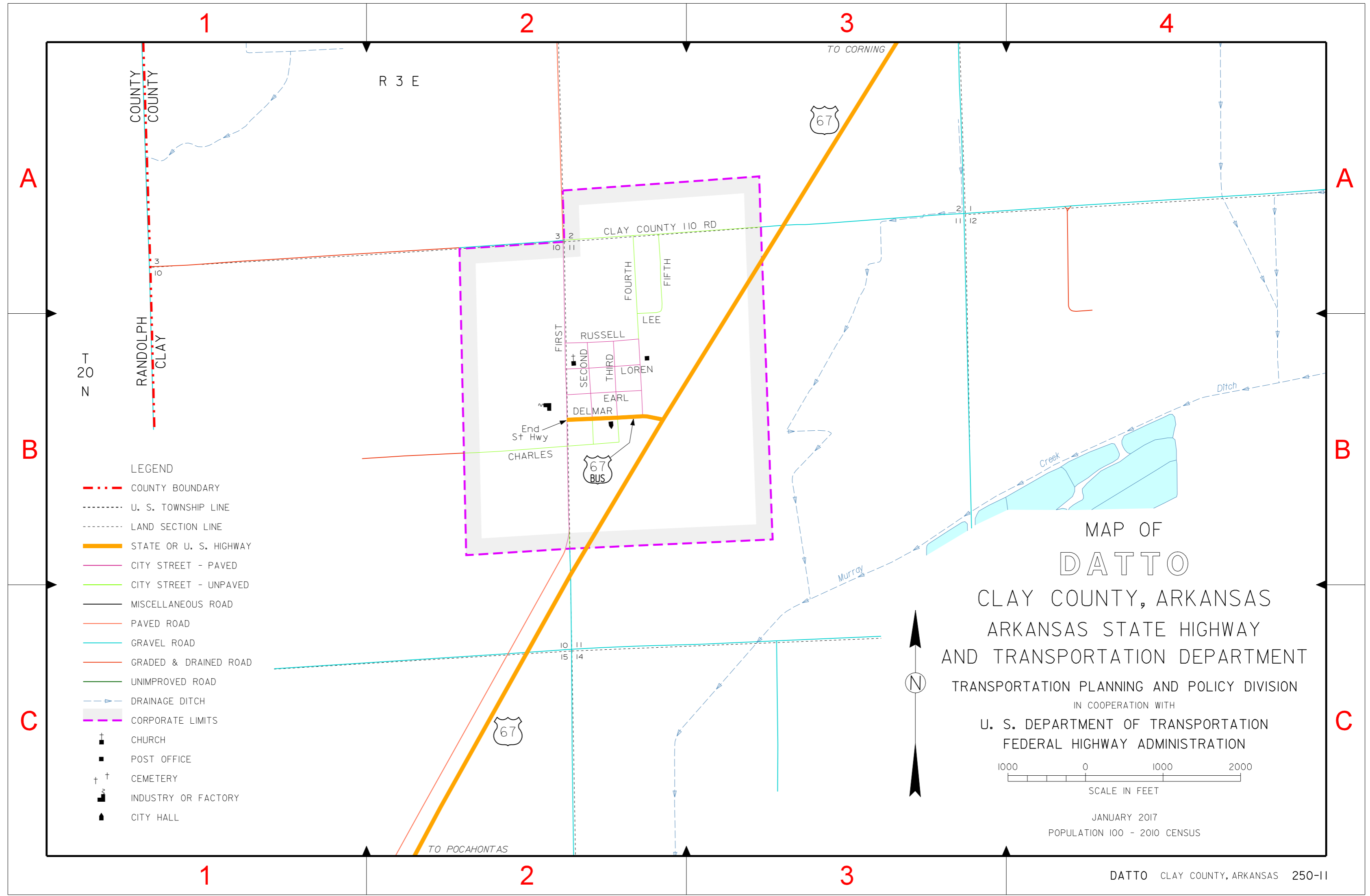

T 20 N

R 3 E

TO CORNING

TO POCAHONTAS

- LEGEND
- COUNTY BOUNDARY
  - U. S. TOWNSHIP LINE
  - LAND SECTION LINE
  - STATE OR U. S. HIGHWAY
  - CITY STREET - PAVED
  - CITY STREET - UNPAVED
  - MISCELLANEOUS ROAD
  - PAVED ROAD
  - GRAVEL ROAD
  - GRADED & DRAINED ROAD
  - UNIMPROVED ROAD
  - DRAINAGE DITCH
  - CORPORATE LIMITS
  - +
 CHURCH
  - 
 POST OFFICE
  - + †
 CEMETERY
  - 
 INDUSTRY OR FACTORY
  - ▲
 CITY HALL

MAP OF  
**DATTO**  
 CLAY COUNTY, ARKANSAS  
 ARKANSAS STATE HIGHWAY  
 AND TRANSPORTATION DEPARTMENT  
 TRANSPORTATION PLANNING AND POLICY DIVISION  
 IN COOPERATION WITH  
 U. S. DEPARTMENT OF TRANSPORTATION  
 FEDERAL HIGHWAY ADMINISTRATION



JANUARY 2017  
 POPULATION 100 - 2010 CENSUS