

INDEX

ALEXANDER AVE	C-2
ASH	C-2
BERNEY	B-2
BOOKER	B-2
BRADSHER	C-1
BURTON	C-2
CARLA CV	B-1
CHARLES	B-3
CONGO AVE	B-1
DANETTE DR	B-2
DEWEY	C-2
DIANA	C-1
DIDEMMA	B-3
DONNA DR	B-1
E BROAD	B-3
EASON AVE	B-1
EDGEWOOD	C-2
ELM	C-2
FRONT	B-3
GREENWOOD AVE	C-2
HOLMES	B-2
HUGH AVE	B-2
J MARTIN RD	C-3
JAMES	B-2
JOYCE	B-2
JULIANNE	C-2
JULIET	B-3
KENNEMORE	B-3
KENWOOD AVE	C-2
MAPLE	C-2
MARLENE DR	C-3
MAYS	C-1
MCCLELLAN AVE	C-2
MILES	C-2
MILLS CR	B-2
N SCHOOL DR	C-2
NEELY	B-3
OAK	C-2
PAUL	B-3
PORTIS	B-2
POWELL AVE	C-2
RIVERSIDE	B-2
RIVERSIDE DR	B-2
ROMEO CR	B-1
RUSSELL	C-3
S SCHOOL DR	C-2
STEVENS	C-2
STEVENS SQ	C-2
SYCAMORE	B-2
THELMA	B-3
THOMAS	B-2
THOMPSON	C-2
W BROAD	B-2
W SCHOOL DR	C-2
WILL HENRY DR	B-3
WOODLAND	C-3
WOODROE	C-2

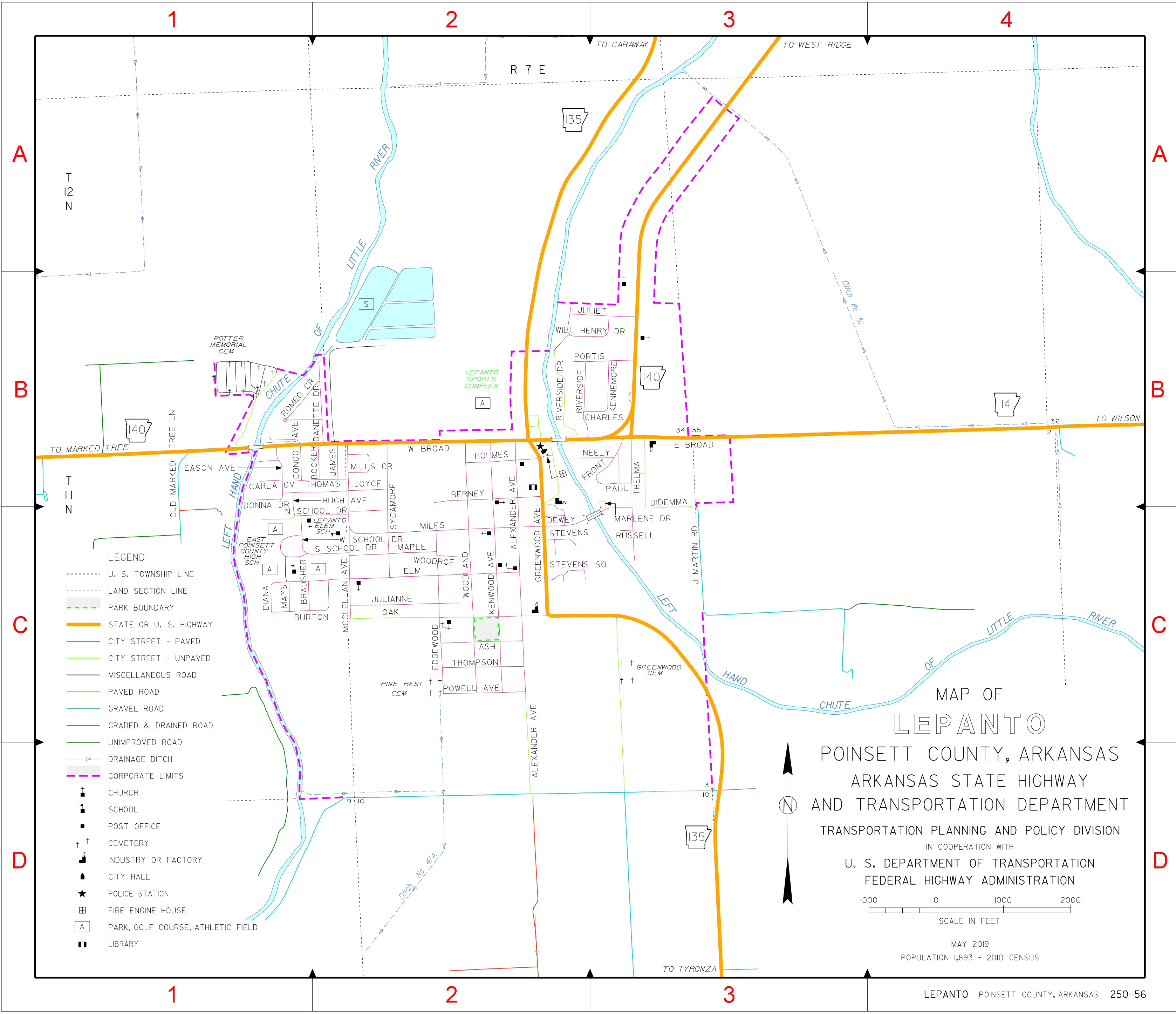

- LEGEND**
- U. S. TOWNSHIP LINE
 - LAND SECTION LINE
 - PARK BOUNDARY
 - STATE OR U. S. HIGHWAY
 - CITY STREET - PAVED
 - CITY STREET - UNPAVED
 - MISCELLANEOUS ROAD
 - PAVED ROAD
 - GRAVEL ROAD
 - GRADED & DRAINED ROAD
 - UNIMPROVED ROAD
 - DRAINAGE DITCH
 - CORPORATE LIMITS
 - + CHURCH
 - SCHOOL
 - POST OFFICE
 - + CEMETERY
 - INDUSTRY OR FACTORY
 - ▲ CITY HALL
 - ★ POLICE STATION
 - FIRE ENGINE HOUSE
 - PARK, GOLF COURSE, ATHLETIC FIELD
 - LIBRARY

MAP OF LEPANTO
 POINSETT COUNTY, ARKANSAS
 ARKANSAS STATE HIGHWAY
 AND TRANSPORTATION DEPARTMENT
 TRANSPORTATION PLANNING AND POLICY DIVISION
 IN COOPERATION WITH
 U. S. DEPARTMENT OF TRANSPORTATION
 FEDERAL HIGHWAY ADMINISTRATION

1000 0 1000 2000
 SCALE IN FEET

MAY 2019
 POPULATION 1,893 - 2010 CENSUS