

INDEX

- CARR B-3
- CHIGGER VALLEY RD A-3
- COLLEGE AVE B-3
- E ANDERSON B-3
- E COUNTY ROAD A-2
- E CRAWFORD B-3
- E ELLINGTON B-3
- E GROVE B-3
- E POWELL B-3
- E PRIDDY B-3
- E SCOTT B-3
- E STATE B-3
- HOOPER B-3
- KENNEDY B-3
- MILL B-3
- N CHURCH B-2
- N GARLAND B-2
- N OLIVER B-3
- N PETIT JEAN B-2
- N REVILLE B-2
- N REVILLE B-3
- N SCHOOL B-3
- N UNION B-2
- N WOOD B-2
- PAGE LN B-2
- PENDLETON B-2
- S CHURCH B-2
- S GARLAND B-2
- S OLIVER B-3
- S PETIT JEAN C-2
- S REVILLE C-3
- S UNION B-2
- S WOOD B-2
- SHEPPARD LN A-2
- W ANDERSON B-2
- W CHESTER B-2
- W CRAWFORD B-2
- W ELLINGTON B-2
- W GROVE B-2
- W POWELL B-2
- W PRIDDY B-2
- W SCOTT B-2
- W STATE B-2
- WATSON B-3

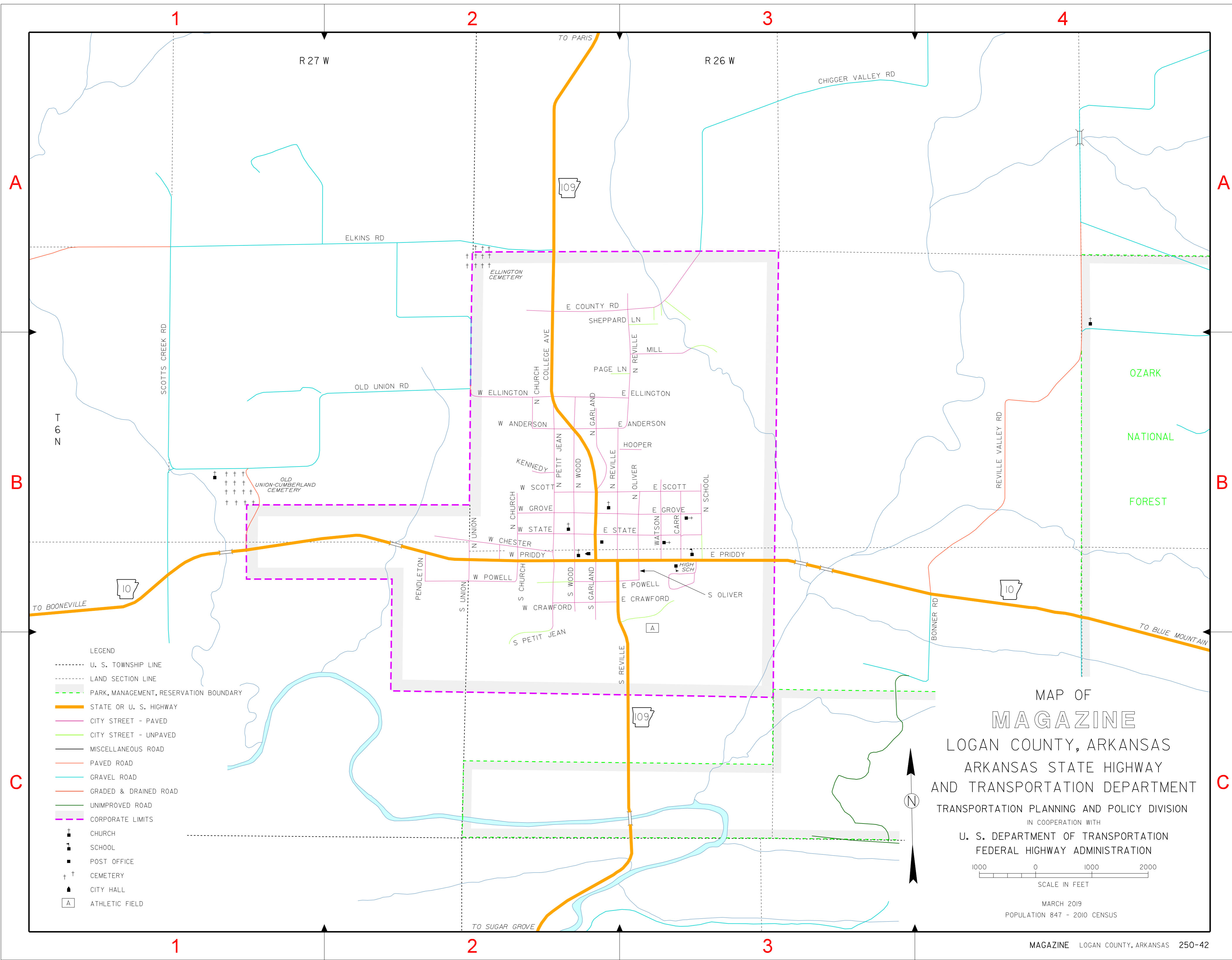

- LEGEND
- U. S. TOWNSHIP LINE
 - LAND SECTION LINE
 - PARK, MANAGEMENT, RESERVATION BOUNDARY
 - STATE OR U. S. HIGHWAY
 - CITY STREET - PAVED
 - CITY STREET - UNPAVED
 - MISCELLANEOUS ROAD
 - PAVED ROAD
 - GRAVEL ROAD
 - GRADED & DRAINED ROAD
 - UNIMPROVED ROAD
 - CORPORATE LIMITS
 - † CHURCH
 - SCHOOL
 - POST OFFICE
 - †† CEMETERY
 - ▲ CITY HALL
 - ATHLETIC FIELD

MAP OF
MAGAZINE
 LOGAN COUNTY, ARKANSAS
 ARKANSAS STATE HIGHWAY
 AND TRANSPORTATION DEPARTMENT
 TRANSPORTATION PLANNING AND POLICY DIVISION
 IN COOPERATION WITH
 U. S. DEPARTMENT OF TRANSPORTATION
 FEDERAL HIGHWAY ADMINISTRATION

1000 0 1000 2000
 SCALE IN FEET

MARCH 2019
 POPULATION 847 - 2010 CENSUS