

INDEX

- | | |
|----------------|-----|
| 3 RD | B-2 |
| E FRANKLIN | B-3 |
| E MAPLE | B-3 |
| E MILL | B-3 |
| E WARNER | B-3 |
| E WASHINGTON | B-3 |
| E WILLIFORD | B-3 |
| ENGLAND | B-2 |
| GREYHOUND DR | B-2 |
| INDUSTRIAL AVE | B-3 |
| LONG | B-3 |
| N 2 ND | B-2 |
| N 3 RD | B-2 |
| N 4 TH | B-2 |
| N 5 TH | B-2 |
| N 6 TH | B-2 |
| N 7 TH | B-2 |
| N 9 TH | B-2 |
| N BUD | B-3 |
| N END AVE | B-2 |
| N FIRST | B-2 |
| N PARK | B-2 |
| OLLIE | B-2 |
| PLATEAU LN | A-3 |
| RAILROAD AVE | B-3 |
| S 2 ND | B-3 |
| S 4 TH | B-2 |
| S 5 TH | B-2 |
| S 6 TH | B-2 |
| S 7 TH | B-2 |
| S BUD | B-3 |
| S FIRST | B-3 |
| SHORT | B-3 |
| SOUTHSIDE DR | A-3 |
| SUNSET DR | A-3 |
| W FRANKLIN | B-2 |
| W MAIN | B-2 |
| W MILL | B-2 |
| W TEDDY | B-2 |
| W WASHINGTON | B-2 |
| W WILLIFORD | B-2 |
| WARNER | B-2 |

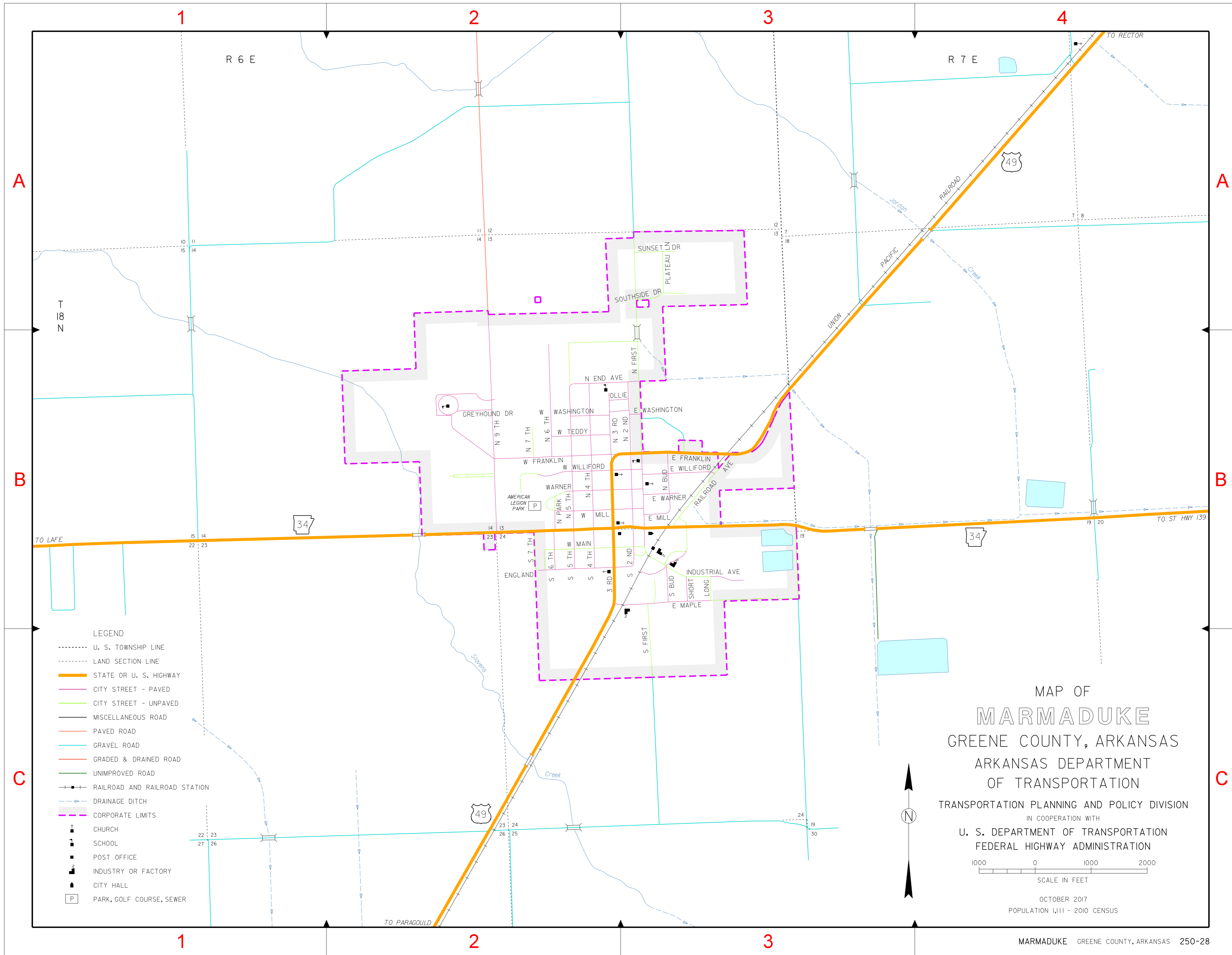

- LEGEND**
- U. S. TOWNSHIP LINE
 - LAND SECTION LINE
 - STATE OR U. S. HIGHWAY
 - CITY STREET - PAVED
 - CITY STREET - UNPAVED
 - MISCELLANEOUS ROAD
 - PAVED ROAD
 - GRAVEL ROAD
 - GRADED & DRAINED ROAD
 - UNIMPROVED ROAD
 - RAILROAD AND RAILROAD STATION
 - DRAINAGE DITCH
 - CORPORATE LIMITS
 - † CHURCH
 - ▣ SCHOOL
 - ▣ POST OFFICE
 - ▣ INDUSTRY OR FACTORY
 - ▣ CITY HALL
 - ▣ PARK, GOLF COURSE, SEWER

MAP OF
MARMADUKE
 GREENE COUNTY, ARKANSAS
 ARKANSAS DEPARTMENT
 OF TRANSPORTATION

TRANSPORTATION PLANNING AND POLICY DIVISION
 IN COOPERATION WITH
 U. S. DEPARTMENT OF TRANSPORTATION
 FEDERAL HIGHWAY ADMINISTRATION



OCTOBER 2017
 POPULATION 1,111 - 2010 CENSUS