

INDEX

ASH
BROWN LN
BRYAN
CHURCH
CODY
COLE
DEBBIE
EUBANKS
HORTON LN
JAMISON
JERI ANN
JOHNSON RD
KATHLEEN DR
KENNETH
KIMBERLY DR
LANCASTER DR
LEE
LINDSEY LN
MASON
MESSER DR
OAK GROVE RD
OAK GROVE RD
SANDERS
SEASONS
SHANE DR
SMOTHERS
STORMES
SUNSET RD
TWIN LAKE
VAUGHN
VAUGHN
WARNER
WINN

A-2
B-2
C-2
C-3
B-2
A-2
C-2
A-1
C-1
B-2
C-3
B-2
C-3
C-3
A-2
A-2
C-2
A-1
C-1
B-2
C-3
A-2
C-2
C-3
C-2

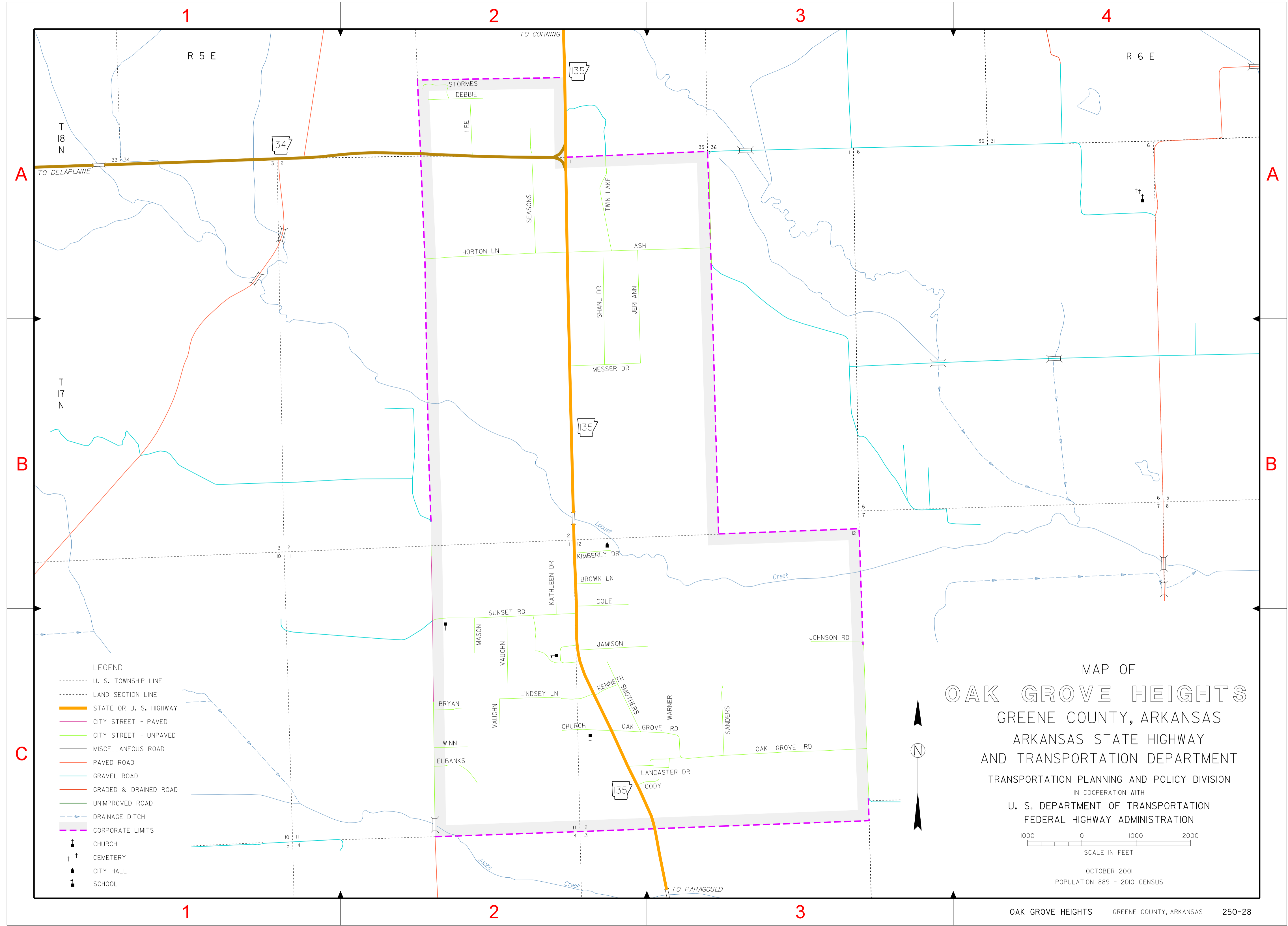

A

B

C

A

B

1

2

3

4

1

2

3

- LEGEND**
- U. S. TOWNSHIP LINE
 - LAND SECTION LINE
 - STATE OR U. S. HIGHWAY
 - CITY STREET - PAVED
 - CITY STREET - UNPAVED
 - MISCELLANEOUS ROAD
 - PAVED ROAD
 - GRAVEL ROAD
 - GRADED & DRAINED ROAD
 - UNIMPROVED ROAD
 - DRAINAGE DITCH
 - CORPORATE LIMITS
 - CHURCH
 - CEMETERY
 - CITY HALL
 - SCHOOL

MAP OF
OAK GROVE HEIGHTS
GREENE COUNTY, ARKANSAS
ARKANSAS STATE HIGHWAY
AND TRANSPORTATION DEPARTMENT
TRANSPORTATION PLANNING AND POLICY DIVISION
IN COOPERATION WITH
U. S. DEPARTMENT OF TRANSPORTATION
FEDERAL HIGHWAY ADMINISTRATION



OCTOBER 2001
POPULATION 889 - 2010 CENSUS