

INDEX

- ARNETT A-4
- BLANCHE B-4
- CARROLL B-4
- CHANEY B-5
- CHARCOAL RD B-5
- CLINTON B-2
- COTTON A-4
- CRESCENT DR C-4
- DANLEY B-5
- F ACADEMY B-4
- ARCH B-4
- BROWN C-4
- CARNEY B-4
- CHISM B-4
- CHISM B-6
- CHURCH B-4
- CHURCH B-6
- DANLEY B-4
- FULLER C-5
- GROBER C-4
- HALL A-4
- HARKEY B-4
- KLEIN B-4
- MAIN B-4
- MAPLE B-4
- MARTHA B-4
- MARY B-4
- MARY B-6
- MORGAN A-4
- NEIGHBORS B-5
- OLIVE B-5
- PIERCE B-4
- PINE B-4
- ROSEDALE B-4
- SCHEILE DR B-4
- SHORT MOUNTAIN A-5
- WAH B-4
- WALNUT B-4
- WOOD B-4
- WOODS B-5
- GREEN D-4
- HENSON DR D-4
- KALAMAZOO B-6
- LAKEVIEW DR A-4
- LOGAN DR A-4
- MAGAZINE C-5
- MORGAN B-4
- N 2 ND B-4
- N 3 RD B-4
- N 4 TH B-4
- N 5 TH B-4
- N 6 TH B-4
- N 7 TH B-4
- N 10 TH B-4
- N CARR B-6
- N DANRIDGE B-5
- N ELM A-4
- N EXPRESS B-4
- N FIRST B-5
- N HARLEY B-5
- N HARRISON B-5
- N HICKORY A-4
- N KALAMAZOO B-6
- N LEWIS B-6
- N LOWDER B-5
- N MORGAN B-5
- N PARKER B-5
- N ROSALEE B-3
- N ROSEVILLE B-4
- N SLAUGHTER B-5
- N SPRUCE B-4
- N TUCKER A-5
- OLD AIRPORT ROAD A-5
- PATTERSON B-4
- PENNINGTON DR B-4
- PHILLIPS C-4
- POINDEXTER C-4
- REAMS C-4
- S 2 ND C-4
- S 3 RD C-4
- S 4 TH C-4
- S 5 TH C-4
- S 6 TH C-4
- S 7 TH C-4
- S 8 TH C-4
- S 9 TH C-4
- S 10 TH C-5
- ANN C-3
- CHERRY C-3
- DOUG C-4
- ELM C-4
- EXPRESS C-4
- FIRST C-4
- KALAMAZOO B-5
- LOWDER B-5
- RANDOLPH B-5
- ROSEVILLE C-4
- SPRUCE C-4
- STAFFORD B-2
- S VINE C-4
- S WIGGINS DR C-3
- SCHEILE DR A-4
- TAYLOR C-4
- THOMPSON C-4
- VISTA TER A-4
- W ACADEMY B-4
- W ARCH B-4
- W BRIAN B-3
- W CHISM B-3
- W CHURCH B-3
- W ELIZABETH B-3
- W GROBER C-4
- W KLEIN C-4
- W MAPLE C-4
- W MARTHA B-4
- W MARY B-3
- W MARY B-4
- W MARY B-4
- W MCKEEN B-4
- W SHORT MOUNTAIN B-4
- W WALNUT B-3
- W WHITE C-4
- WILSON C-4
- WOOD B-4
- ZEILER A-4

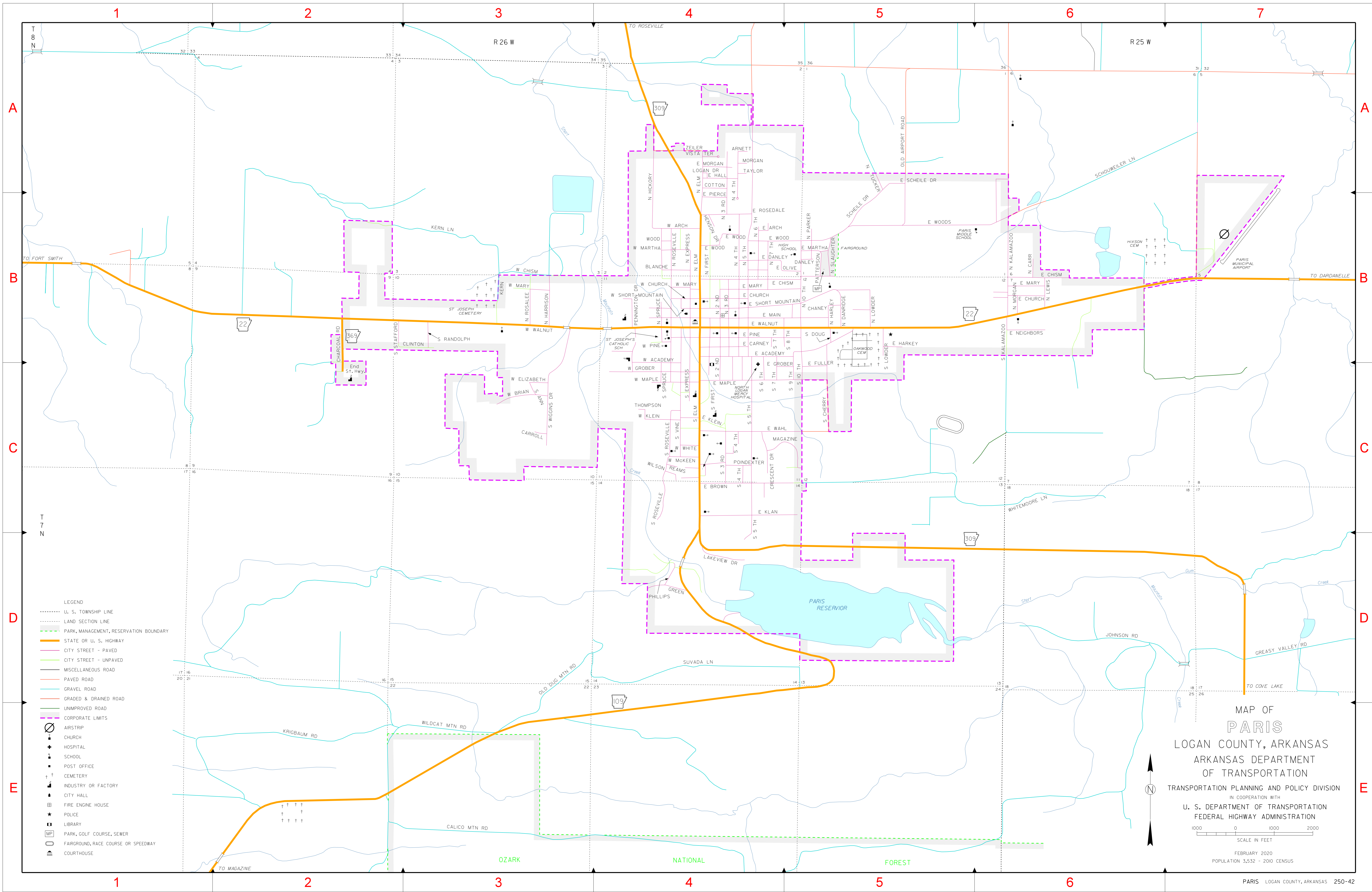

- LEGEND
- U. S. TOWNSHIP LINE
  - LAND SECTION LINE
  - PARK, MANAGEMENT, RESERVATION BOUNDARY
  - STATE OR U. S. HIGHWAY
  - CITY STREET - PAVED
  - CITY STREET - UNPAVED
  - MISCELLANEOUS ROAD
  - PAVED ROAD
  - GRAVEL ROAD
  - GRADED & DRAINED ROAD
  - UNIMPROVED ROAD
  - CORPORATE LIMITS
  - AIRSTRIP
  - CHURCH
  - HOSPITAL
  - SCHOOL
  - POST OFFICE
  - CEMETERY
  - INDUSTRY OR FACTORY
  - CITY HALL
  - FIRE ENGINE HOUSE
  - POLICE
  - LIBRARY
  - PARK, GOLF COURSE, SEWER
  - FAIRGROUND, RACE COURSE OR SPEEDWAY
  - COURTHOUSE

MAP OF  
**PARIS**  
 LOGAN COUNTY, ARKANSAS  
 ARKANSAS DEPARTMENT  
 OF TRANSPORTATION  
 TRANSPORTATION PLANNING AND POLICY DIVISION  
 IN COOPERATION WITH  
 U. S. DEPARTMENT OF TRANSPORTATION  
 FEDERAL HIGHWAY ADMINISTRATION

1000 0 1000 2000  
 SCALE IN FEET

FEBRUARY 2020  
 POPULATION 3,532 - 2010 CENSUS