

INDEX

4 TH
 BATESVILLE BLVD
 BLACKLAND RD
 BURRUSS LN
 CLINTON
 E WOOD
 FLORAL RD
 HAYES
 MEADOW LN
 OAK
 PEACEFUL DR
 ROBERSON DR
 STADIUM
 W WOOD
 WISH

C-3
 B-3
 A-3
 C-3
 C-3
 B-3
 B-3
 C-3
 C-3
 B-3
 B-3
 C-3
 C-3
 C-3

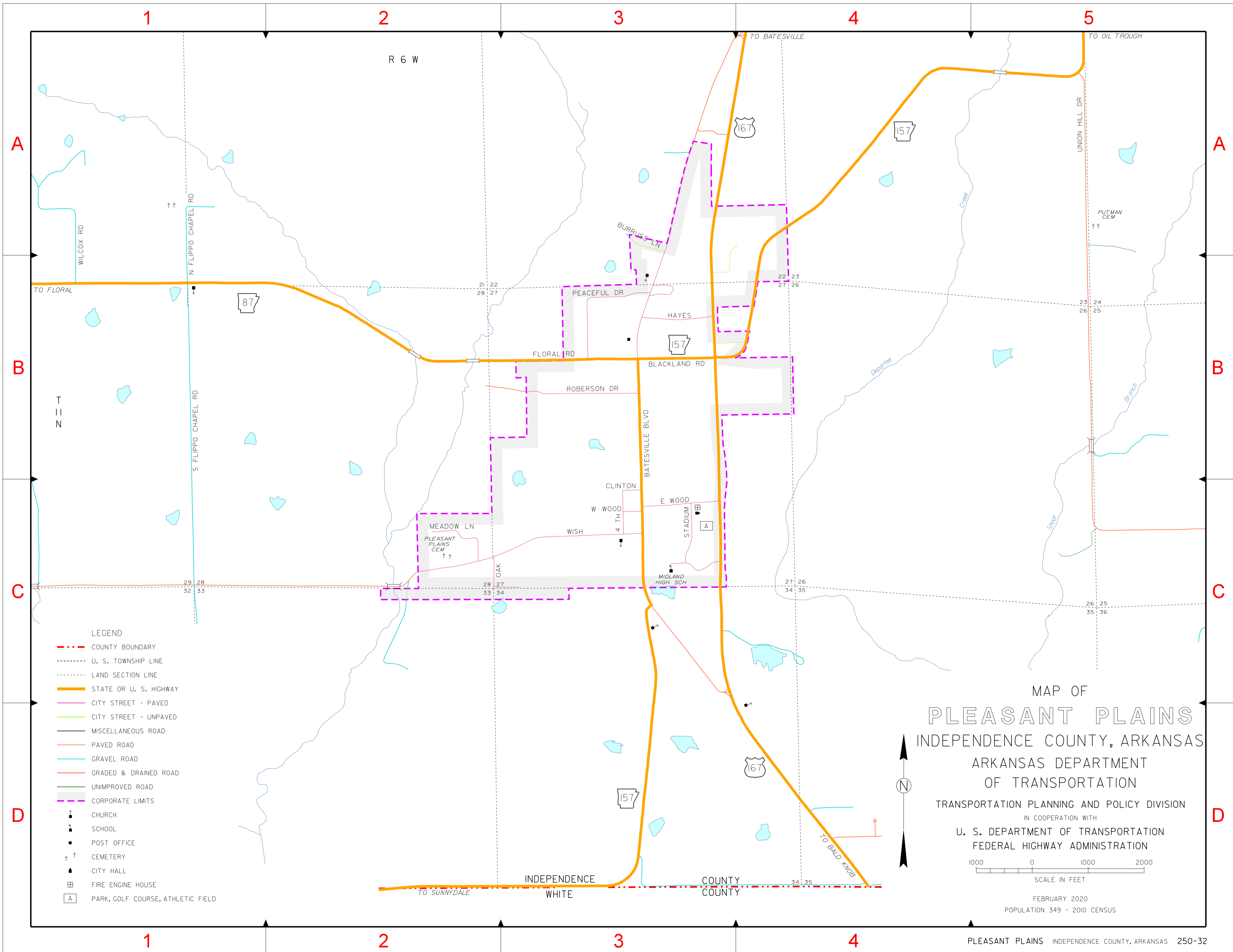

- LEGEND**
- - - COUNTY BOUNDARY
 - - - - - U. S. TOWNSHIP LINE
 - - - - - LAND SECTION LINE
 - STATE OR U. S. HIGHWAY
 - CITY STREET - PAVED
 - CITY STREET - UNPAVED
 - MISCELLANEOUS ROAD
 - PAVED ROAD
 - GRAVEL ROAD
 - GRADED & DRAINED ROAD
 - UNIMPROVED ROAD
 - CORPORATE LIMITS
 - † CHURCH
 - ⌚ SCHOOL
 - POST OFFICE
 - †† CEMETERY
 - ▲ CITY HALL
 - ⊞ FIRE ENGINE HOUSE
 - ⊞ PARK, GOLF COURSE, ATHLETIC FIELD

MAP OF
PLEASANT PLAINS
 INDEPENDENCE COUNTY, ARKANSAS
 ARKANSAS DEPARTMENT
 OF TRANSPORTATION
 TRANSPORTATION PLANNING AND POLICY DIVISION
 IN COOPERATION WITH
 U. S. DEPARTMENT OF TRANSPORTATION
 FEDERAL HIGHWAY ADMINISTRATION

1000 0 1000 2000
 SCALE IN FEET
 FEBRUARY 2020
 POPULATION 349 - 2010 CENSUS