

# INDEX

- ANSELM AVE B-2
- ATHLETIC LP B-2
- AUGUSTINE B-2
- BONIFACE AVE B-2
- "C" B-2
- CARTER LN B-1
- COLUBAN AVE B-2
- CONRAD B-2
- "D" B-2
- E "E" B-2
- E PARISH DR B-3
- ECKART B-2
- ELSKEN B-3
- FREDERICK LP B-2
- JOHN B-2
- MEINRAD AVE B-2
- N EAST AVE B-2
- N LEO AVE B-2
- N SUBIACO AVE B-1
- N THOMAS AVE B-3
- OLD MILITARY RD A-2
- PAUL AVE B-2
- PIUS AVE B-2
- REESE RD B-2
- S EAST AVE B-3
- S LEO AVE B-2
- S SUBIACO AVE B-2
- S THOMAS AVE B-3
- SCHNEIDER DR B-2
- SPIELERVILLE RD A-2
- SUBIACO AVE B-3
- SUNSET LN B-2
- W "E" B-2
- W PARISH DR B-2

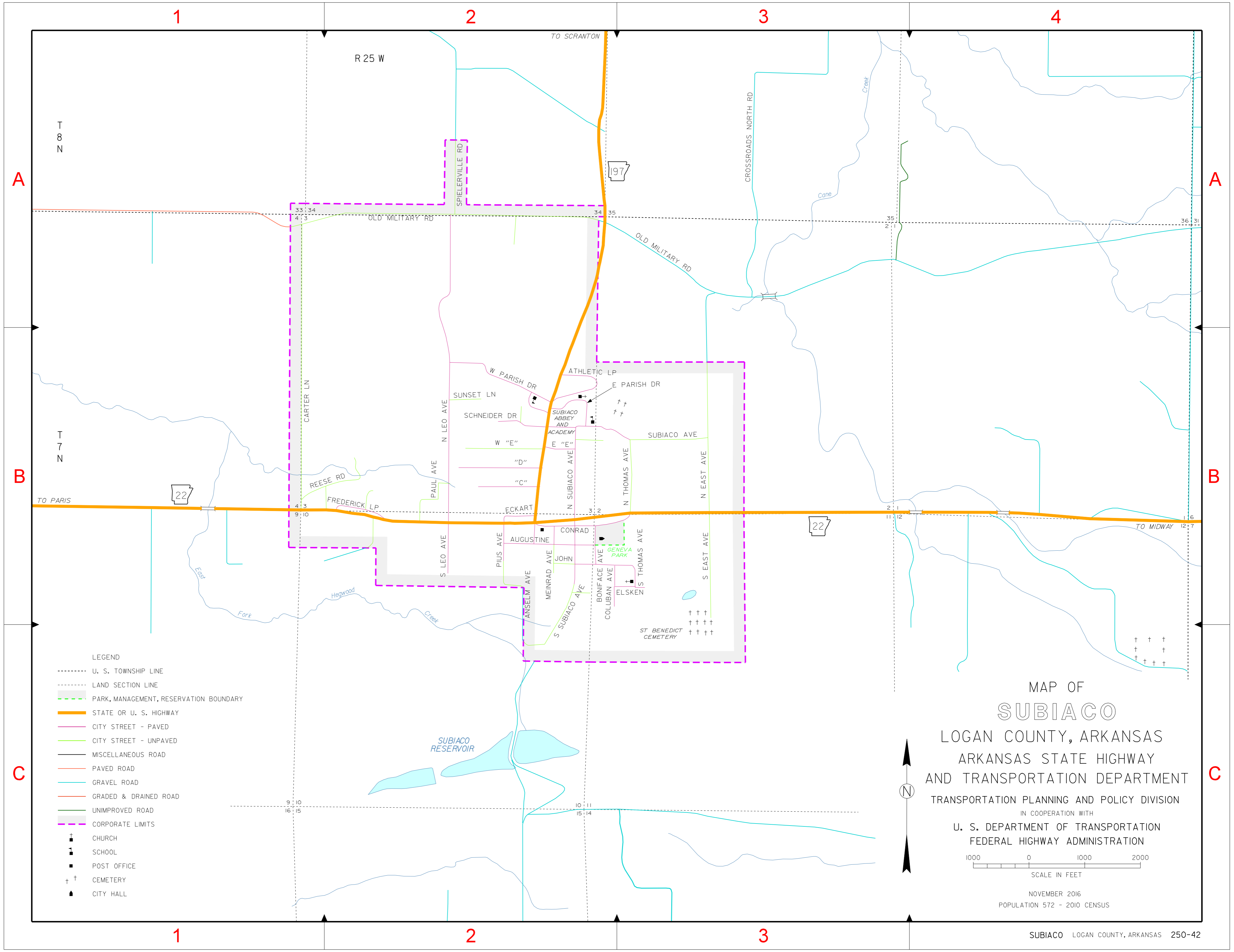

- LEGEND
- U. S. TOWNSHIP LINE
  - LAND SECTION LINE
  - PARK, MANAGEMENT, RESERVATION BOUNDARY
  - STATE OR U. S. HIGHWAY
  - CITY STREET - PAVED
  - CITY STREET - UNPAVED
  - MISCELLANEOUS ROAD
  - PAVED ROAD
  - GRAVEL ROAD
  - GRADED & DRAINED ROAD
  - UNIMPROVED ROAD
  - CORPORATE LIMITS
  - CHURCH
  - SCHOOL
  - POST OFFICE
  - CEMETERY
  - CITY HALL

MAP OF  
**SUBIACO**  
 LOGAN COUNTY, ARKANSAS  
 ARKANSAS STATE HIGHWAY  
 AND TRANSPORTATION DEPARTMENT  
 TRANSPORTATION PLANNING AND POLICY DIVISION  
 IN COOPERATION WITH  
 U. S. DEPARTMENT OF TRANSPORTATION  
 FEDERAL HIGHWAY ADMINISTRATION

1000 0 1000 2000  
 SCALE IN FEET

NOVEMBER 2016  
 POPULATION 572 - 2010 CENSUS