

INDEX

BATESVILLE MOUNTAIN RD A-6
 CAIN LN C-1
 DIAMOND DR C-2
 DOC'S LN C-3
 DOC'S LN C-4
 DOC'S LN C-5
 FIELDS LP C-6
 OLD HIGHWAY 65 C-7
 PINNACLE SPRINGS RD C-8
 PONTIAC LN C-9
 POOLE LN C-10
 SOLOMON GROVE RD C-11
 SOLOMON GROVE RD C-12
 TWIN GROVE LN C-13

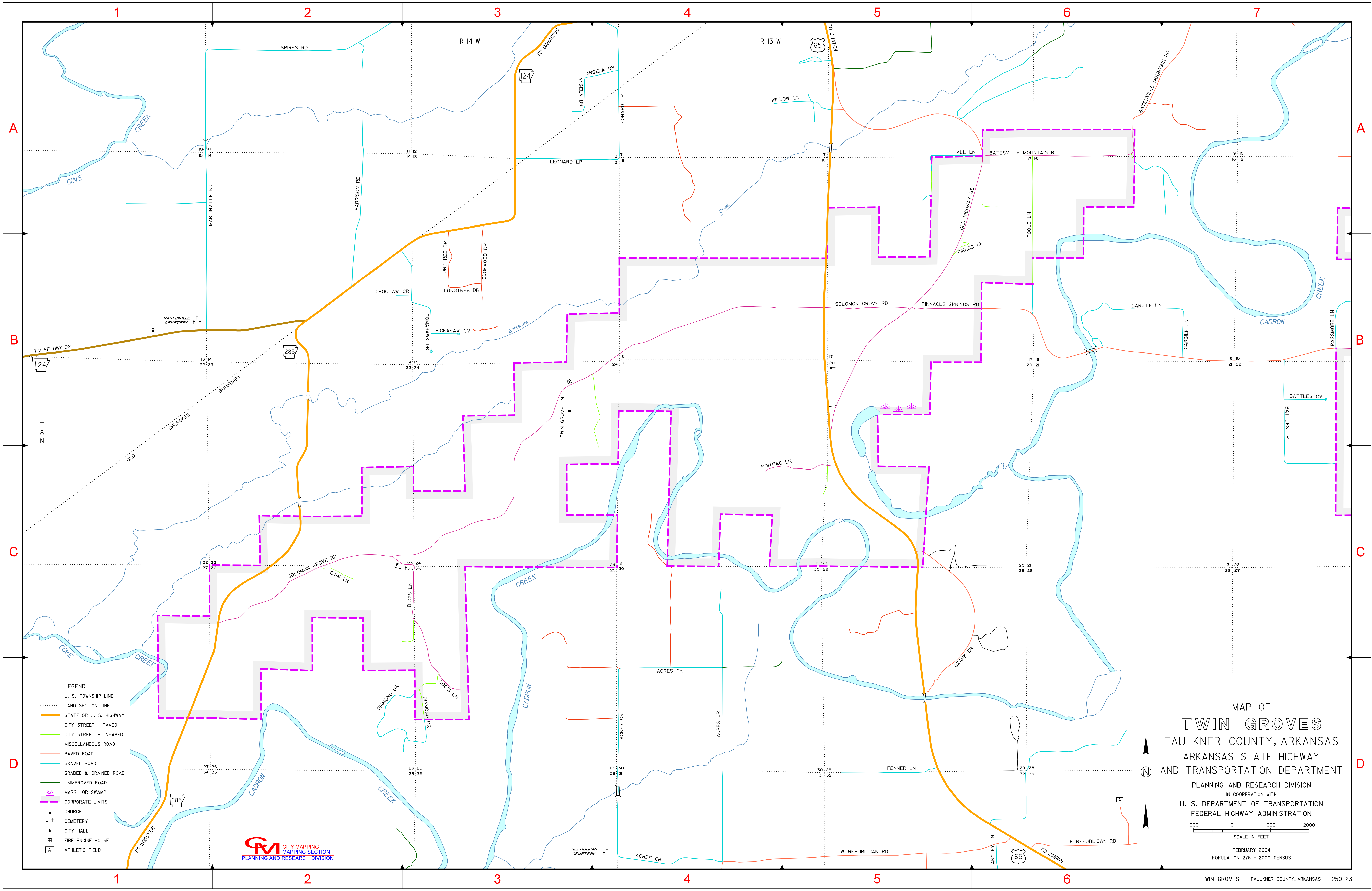

- LEGEND**
- U. S. TOWNSHIP LINE
 - LAND SECTION LINE
 - STATE OR U. S. HIGHWAY
 - CITY STREET - PAVED
 - CITY STREET - UNPAVED
 - MISCELLANEOUS ROAD
 - PAVED ROAD
 - GRAVEL ROAD
 - GRADED & DRAINED ROAD
 - UNIMPROVED ROAD
 - MARSH OR SWAMP
 - CORPORATE LIMITS
 - ↑ CHURCH
 - † CEMETERY
 - ▲ CITY HALL
 - FIRE ENGINE HOUSE
 - ATHLETIC FIELD

CM CITY MAPPING
 MAPPING SECTION
 PLANNING AND RESEARCH DIVISION

MAP OF
TWIN GROVES
 FAULKNER COUNTY, ARKANSAS
 ARKANSAS STATE HIGHWAY
 AND TRANSPORTATION DEPARTMENT
 PLANNING AND RESEARCH DIVISION
 IN COOPERATION WITH
 U. S. DEPARTMENT OF TRANSPORTATION
 FEDERAL HIGHWAY ADMINISTRATION

1000 0 1000 2000
 SCALE IN FEET

FEBRUARY 2004
 POPULATION 276 - 2000 CENSUS